

# CLEVERTOUCH<sup>®</sup>

---

by Boxlight<sup>®</sup>



## Clevershare

Getting started

## Contents

First start up .....	3
Settings .....	4
Permission .....	5
Screen sharing without client .....	6
General .....	7
Help and improvement .....	8
Establishing a connection .....	9
Chromecast .....	9
Airplay (IOS) .....	11
Airplay (MacOS) .....	13
Miracast (Windows) .....	14
Miracast (Android) .....	16
Webcast .....	17
Screen Share .....	18
Desktop Sync .....	19
Clevershare application .....	20
Desktop application (Windows & Chromebook) .....	20
Screen Share .....	21
Desktop Sync .....	23
Desktop application (Mac OS) .....	27
Screen Share .....	28
Desktop Sync .....	30
Privacy Desktop .....	34
Mobile Application (Android & IOS) .....	35
NFC Cast (Android only) .....	36
Screen Grouping .....	37
Creating a group .....	37
Joining a group .....	39
Broadcasting to a group/secondary screen .....	41
Other features .....	42
CleverCast .....	43
Pairing your CleverCast .....	43
Sharing your Clevertouch display/device .....	44
Hardware Virtualization – Teams, Google Meet & Zoom .....	46
FAQ's .....	48

## First start up

Upon first start up, you will be greeted with the following screen. Here you will see your network, Device name, Clevershare code, Menu, Devices, Webcast and a link to a short user guide.

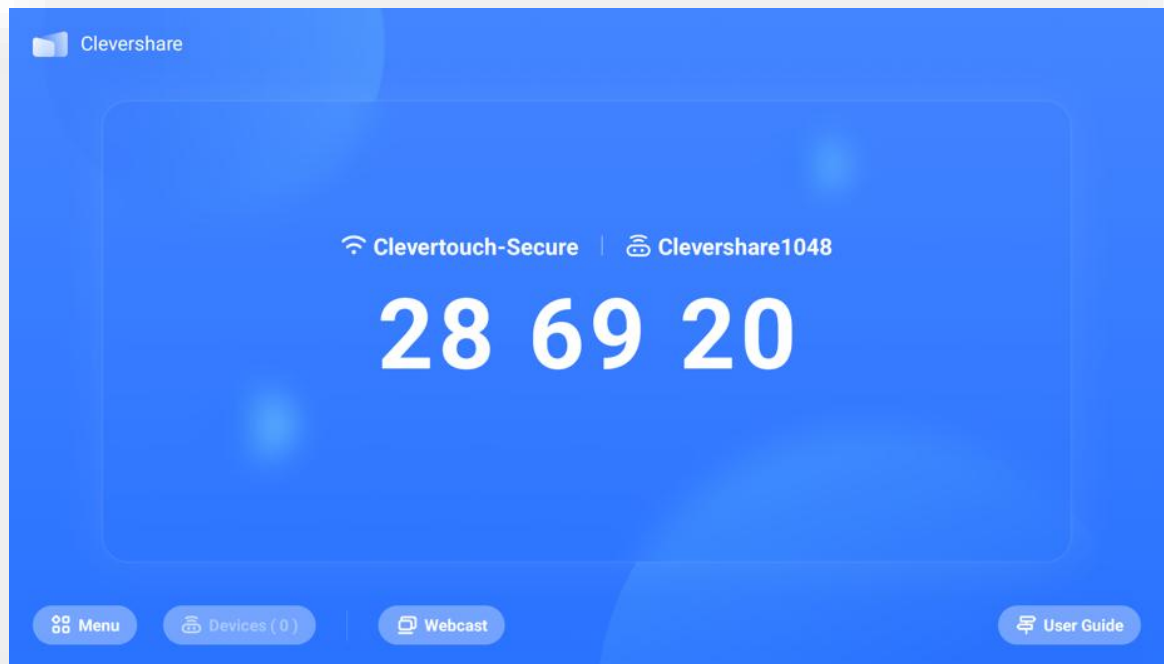

## Settings

Select “Menu” then “Settings”.

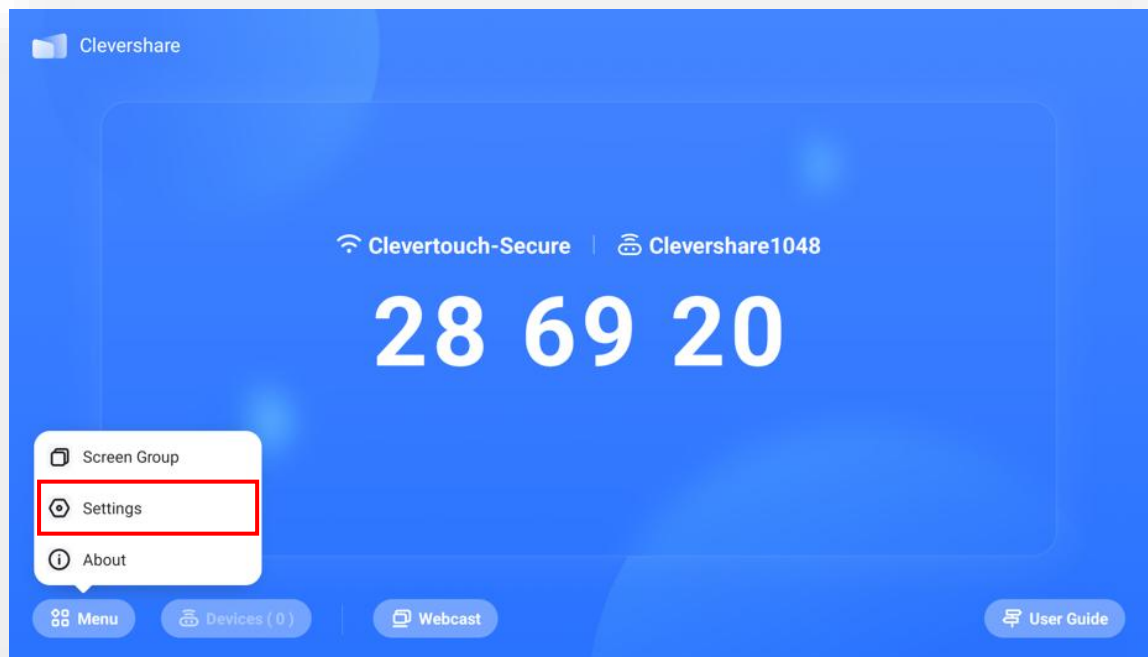

## Permission

### *Allow devices to make quick connection*

When enabled, this allows the user to connect without a code on the Clevershare app on another device.

### *Permission Mode*

When enabled, all devices sharing to the screen will need permission.

### *iPad Touch control*

When enabled, uses Bluetooth connection for touch on iPad.

### *Dongle compatibility mode*

When enabled, lets you use the CleverCast dongle on a PC/Laptop with no network.

### *Settings lock*

When enabled, adds a passcode to the Clevershare settings.

### *30-Devices casting mode*

Cast to 30 devices (default: 9). Excludes No-client mirroring. Performance varies by network/device.

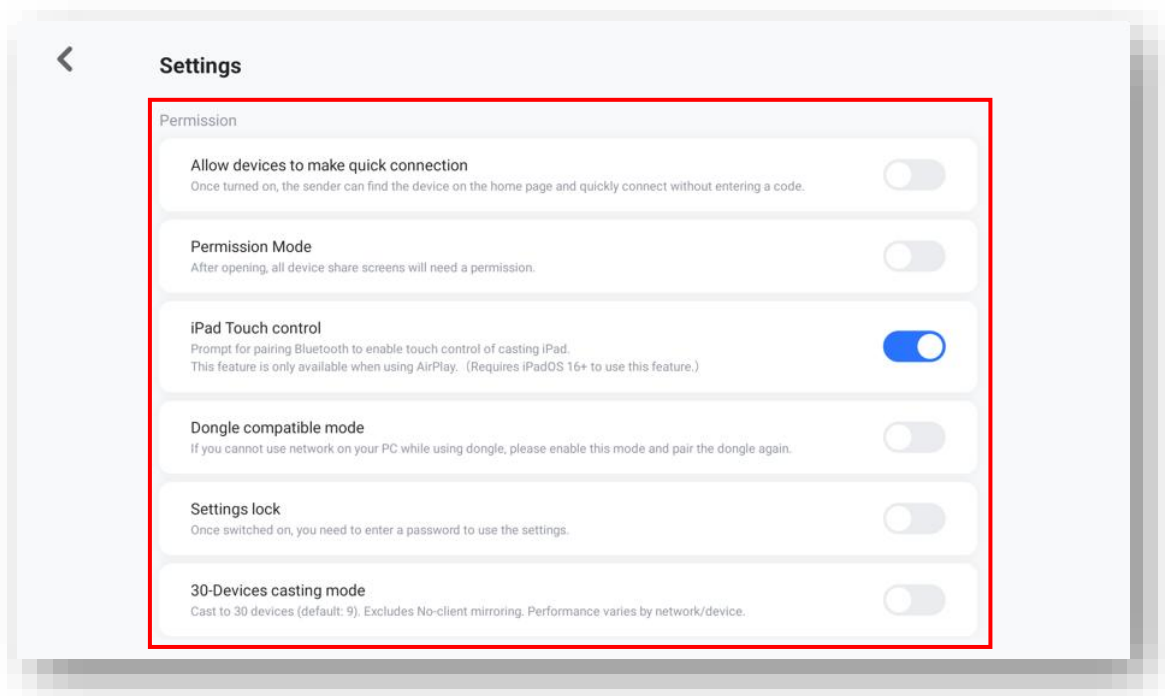

## Screen sharing without client

### *Support Chromecast device*

When enabled, allows casting via Chromecast devices.

### *Support Airplay device*

When enabled, allows streaming or screen mirroring via Airplay.

### *Support Miracast device*

When enabled, allows screen mirroring via Miracast.

### *Support DLNA device*

When enabled, allows media streaming between compatible devices on the same network.

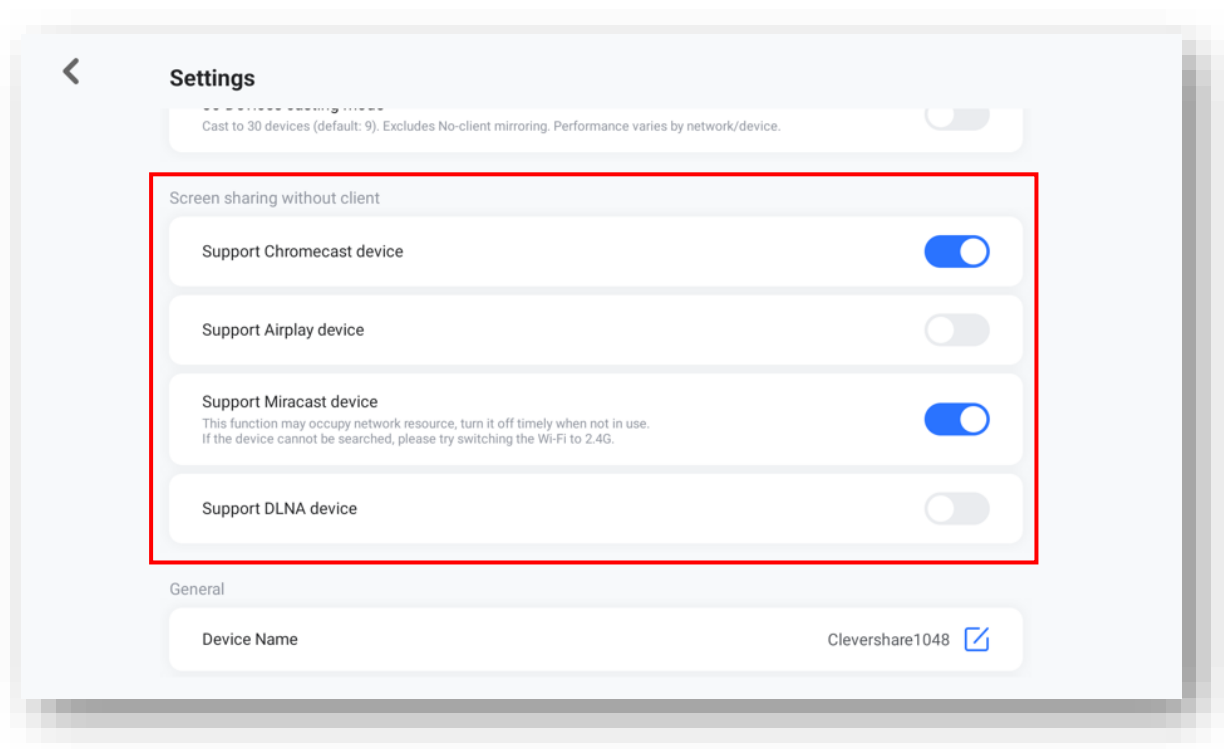

## General

### *Device Name*

Here, you can see the name of your Clevershare, and you can edit the name.

### *Start automatically on boot*

When enabled, Clevershare will open automatically whenever the screen is turned on.

### *Code refresh rate*

Opening the dropdown menu gives you the option to set a timer for the codes refresh rate.

### *Floating window size*

Opening the dropdown menu give you the option to set the floating window size as normal, mini, or removed completely.

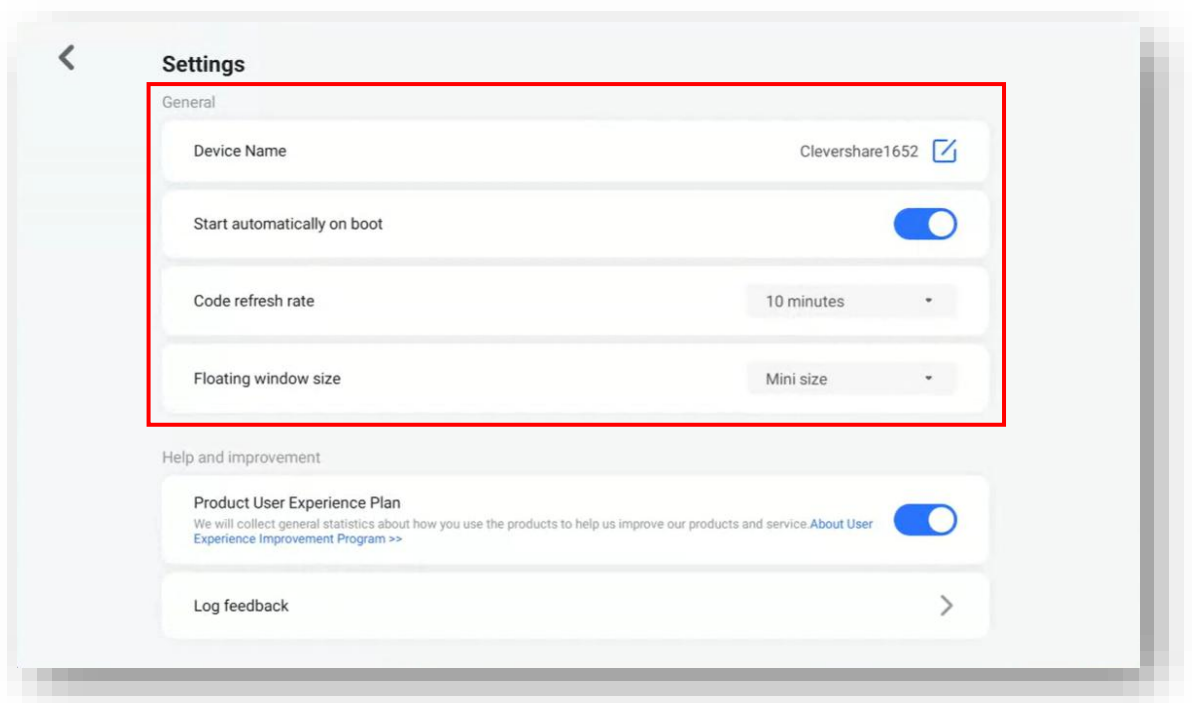

## Help and improvement

### *Product User Experience Plan*

When enabled, will collect general statistics about how you use Clevershare.

### *Log feedback*

Selecting this option, will give you a feedback code for reporting issues.

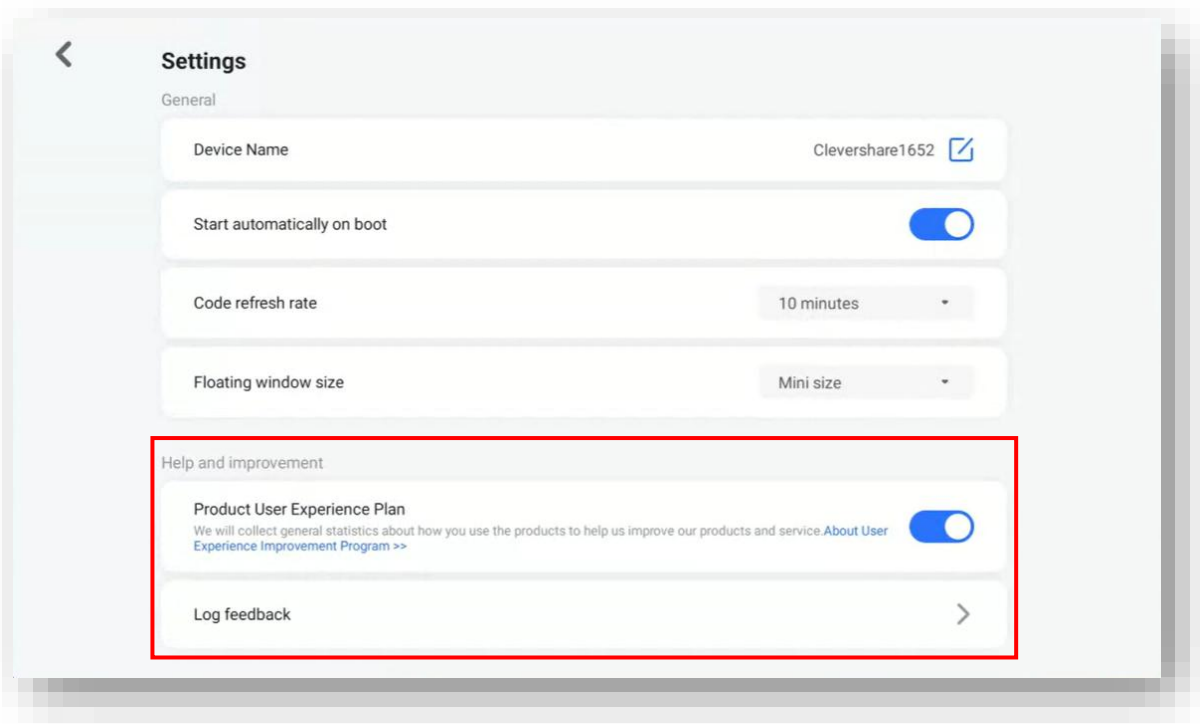



## Establishing a connection

### Chromecast

In your Clevershare settings, enable “Chromecast”.

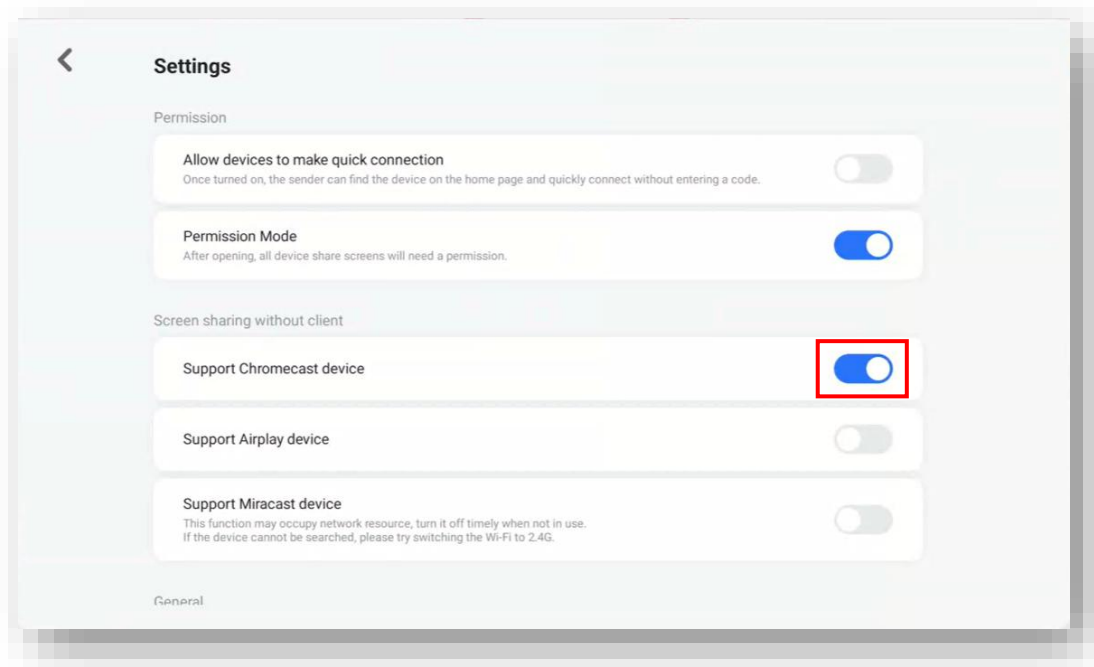

On your Chromecast device, select “Cast Screen”.

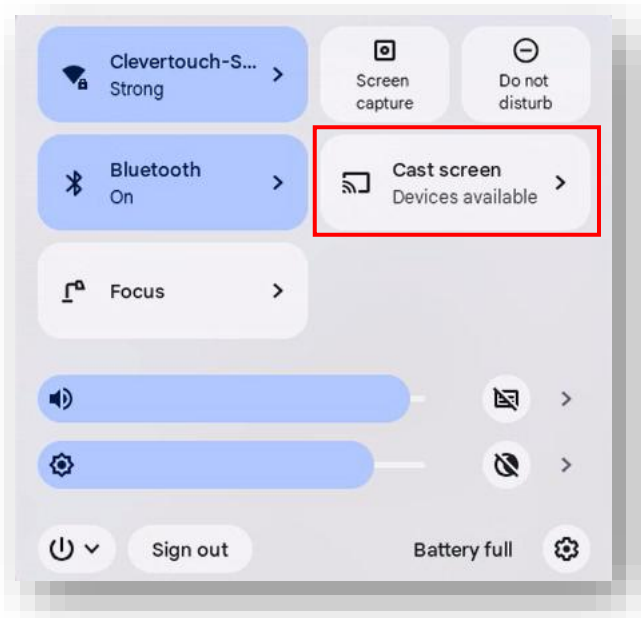

Select your Clevershare.

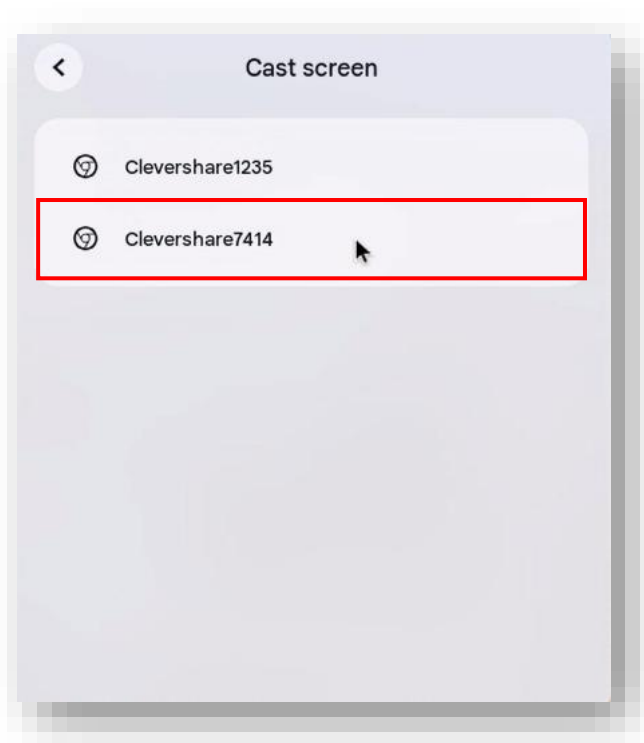

You will see a pop up letting you know that casting has begun.

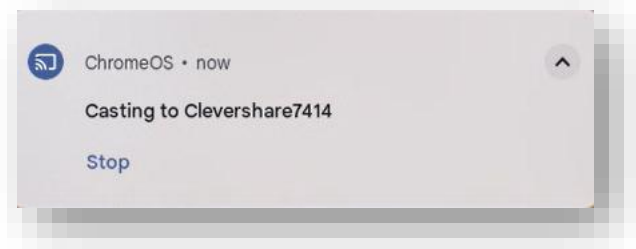

## Airplay (IOS)

In your Clevershare settings, enable “Airplay”.

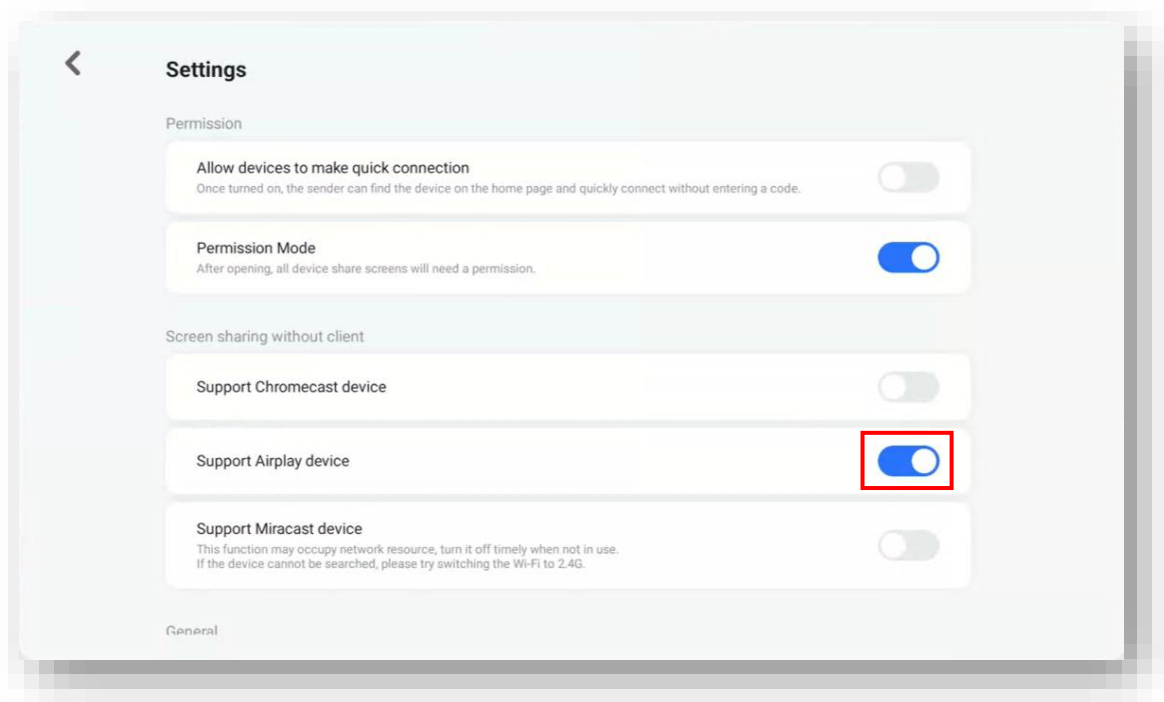

On your iPhone/iPad, select “Screen Mirroring”.



Select your Clevershare.

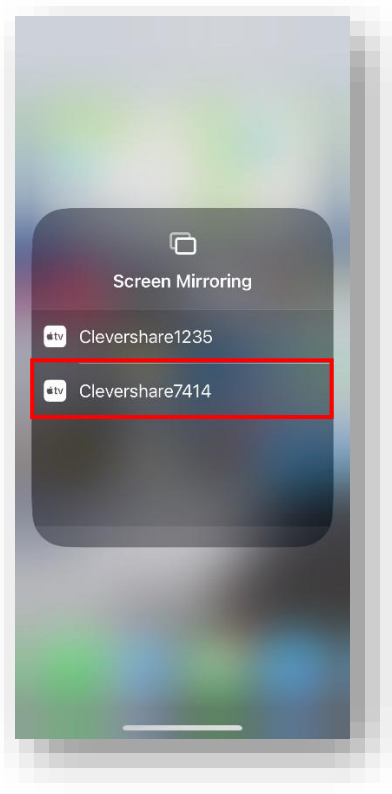

## Airplay (MacOS)

While Airplay is still enabled, select “Screen Mirroring”.

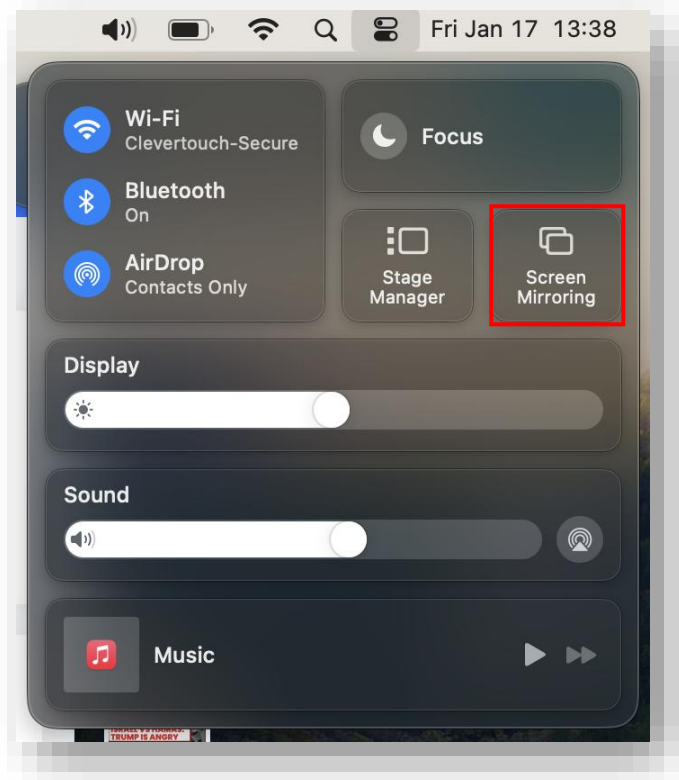

Select your Clevershare

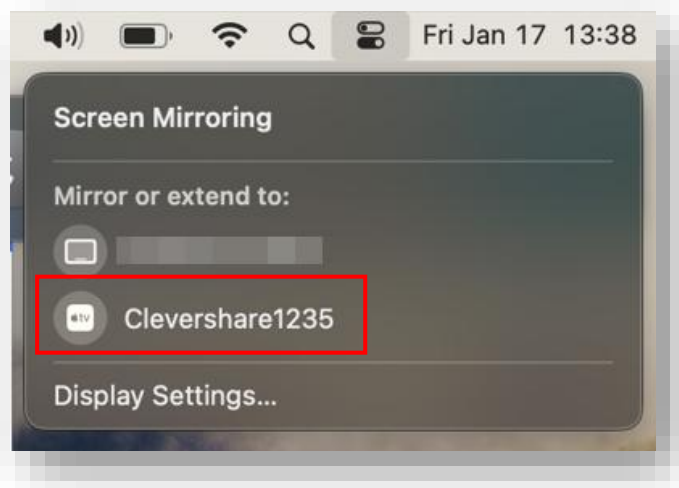

## Miracast (Windows)

In your Clevershare settings, enable “Miracast”.

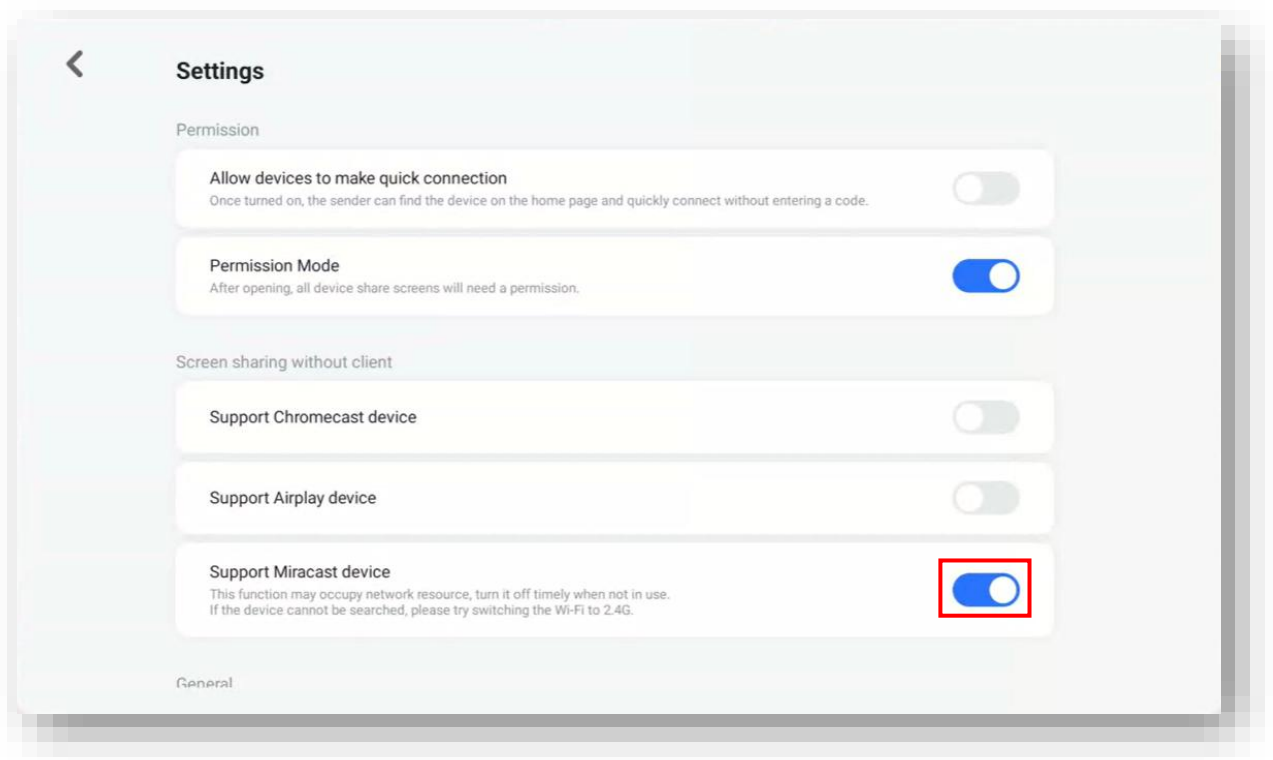

Press “Windows key + K” and select your Clevershare.

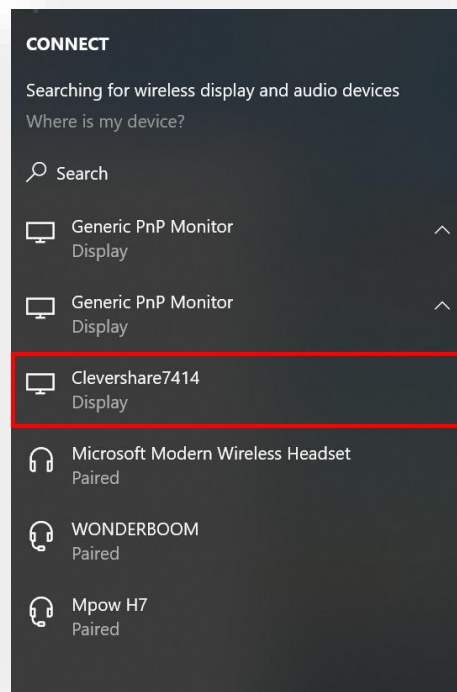

Clevershare will now show as connected

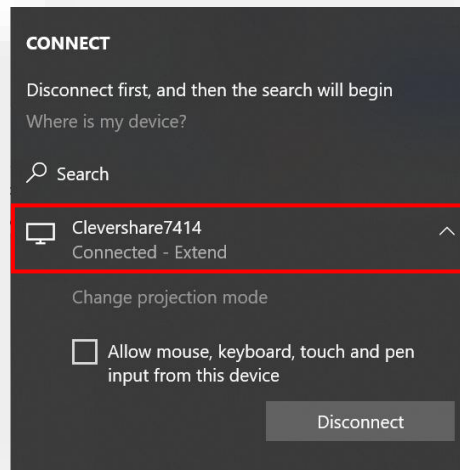

## Miracast (Android)

Whilst Miracast is still enabled, open Smart View then select your Clevershare.

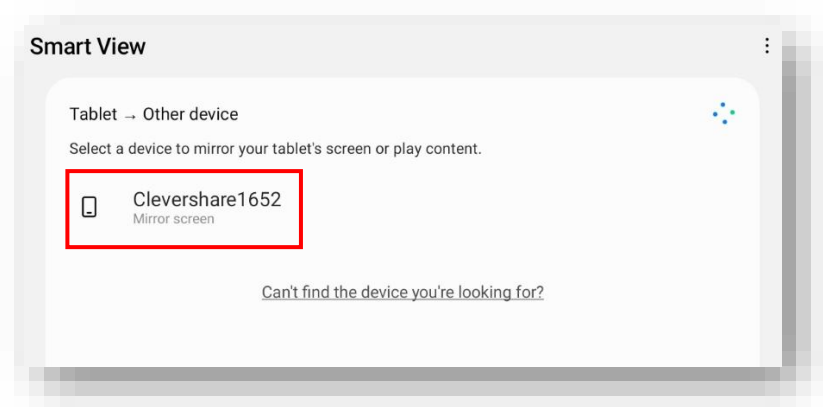

Select “Start now” and mirroring will begin.

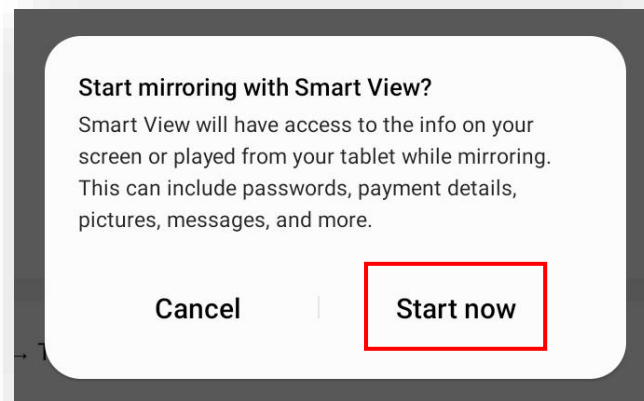



## Webcast

To enable webcast, select “Webcast” and toggle the switch to ON.

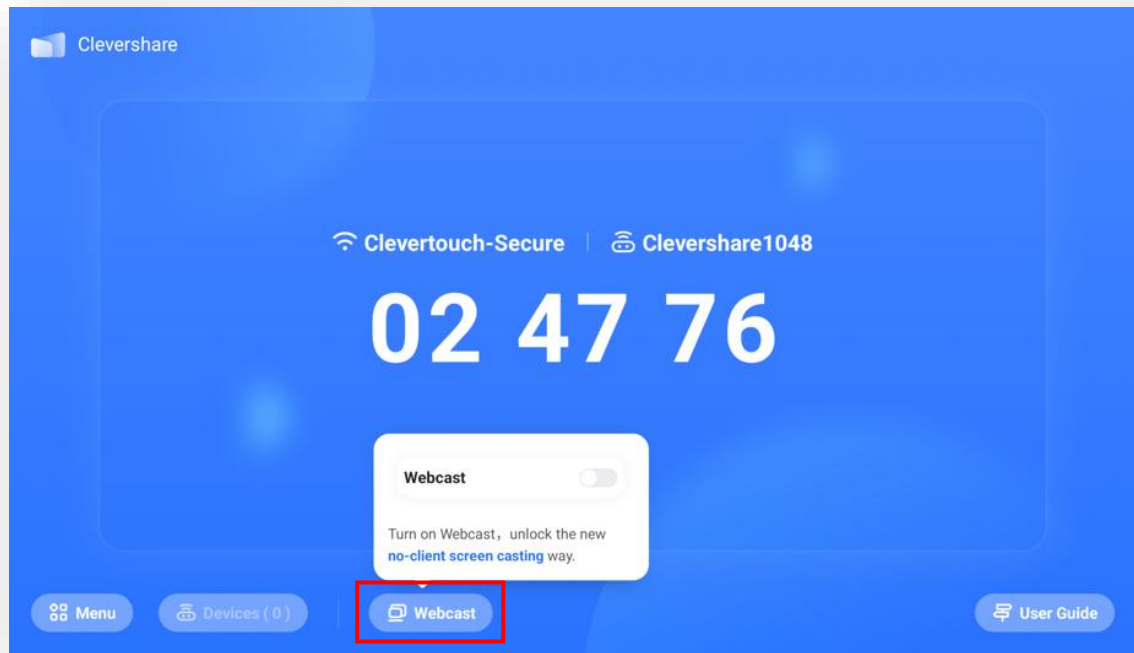

Once enabled your code will change and you will be given instruction on how to start webcasting.

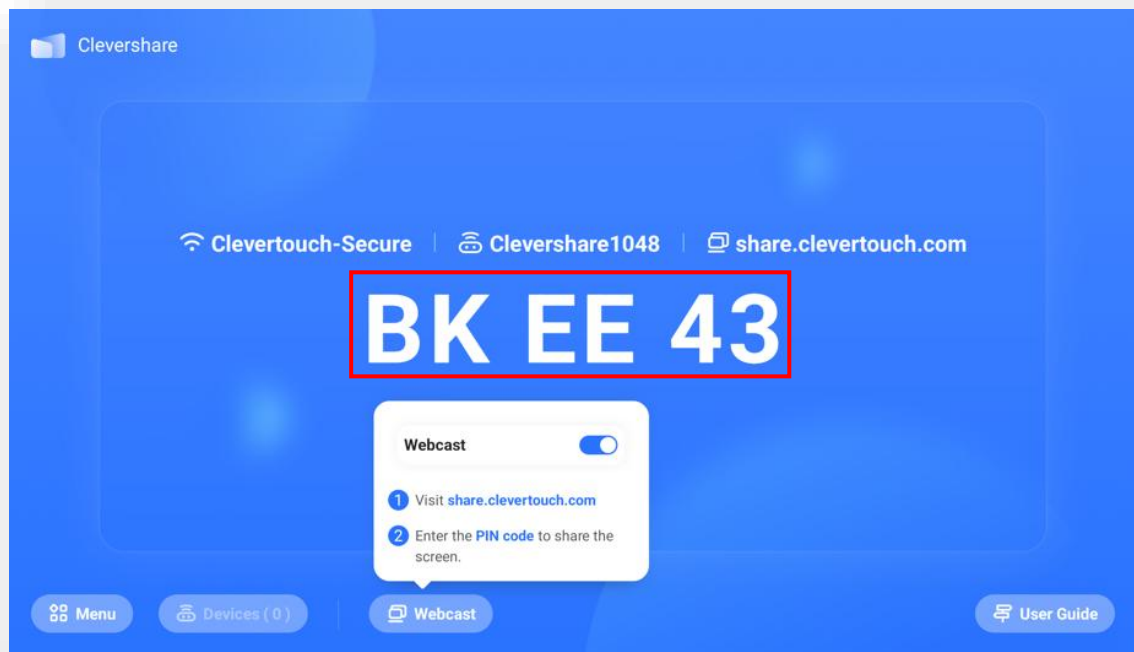

In your browser, visit [share.clevertouch.com](https://share.clevertouch.com) and input the code from your device.



## Screen Share

To begin Screen Share, select “Start”

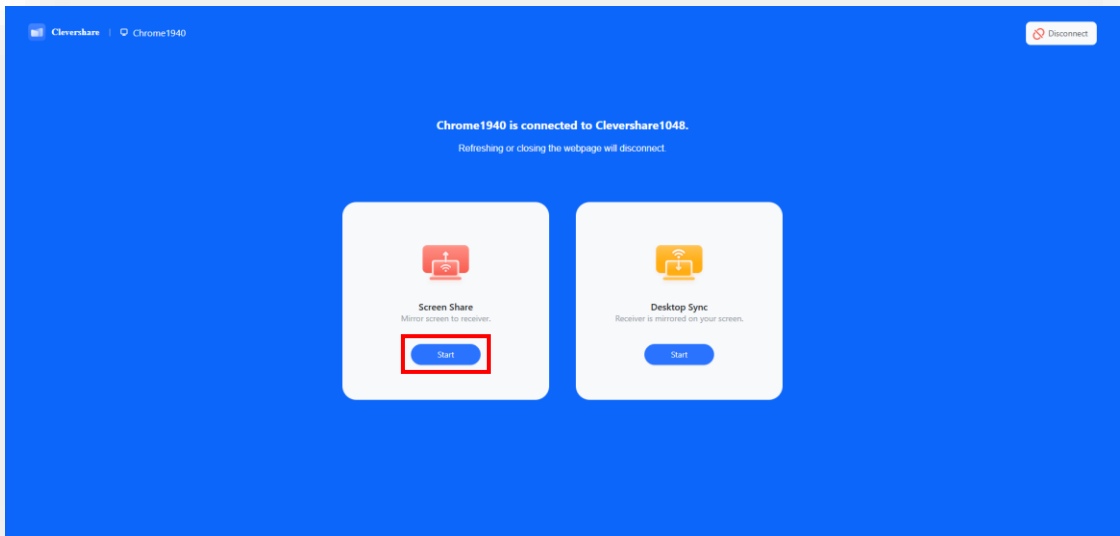

Select the tab, window or the entire screen to share.

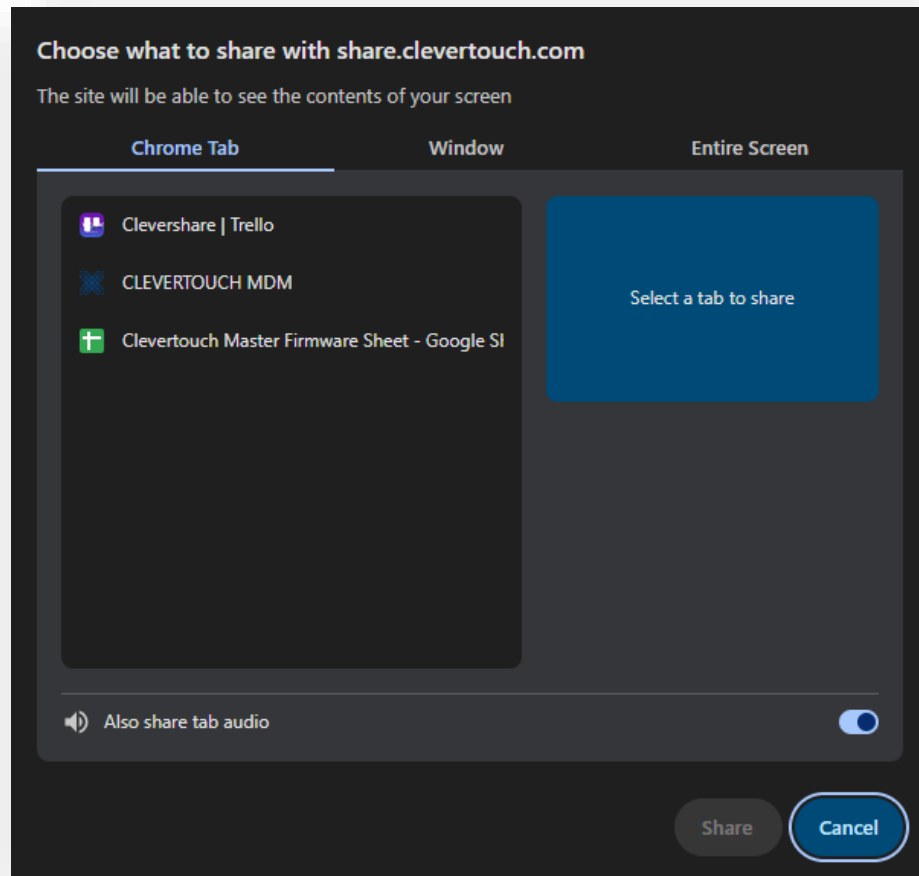

## Desktop Sync

To begin Desktop Sync, select "Start"

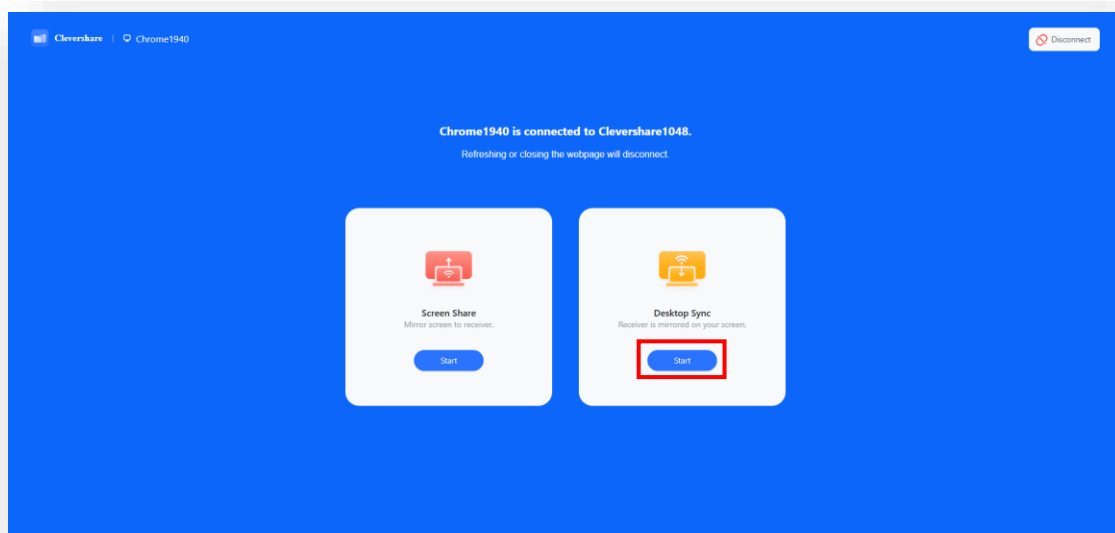

## Clevershare application

**Note:** You can download this app for Windows, Mac and Chromebook, IOS and Android.

### Desktop application (Windows & Chromebook)

When you first open the desktop application, you will need to enter the 6 digit code shown on your Clevertouch screen.

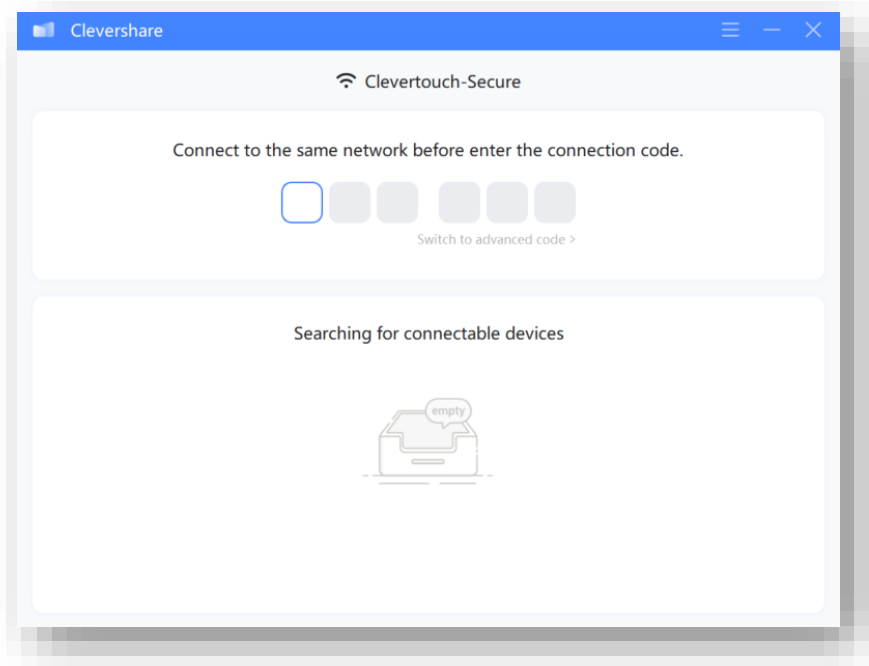

Once connected, you will see the following screen.

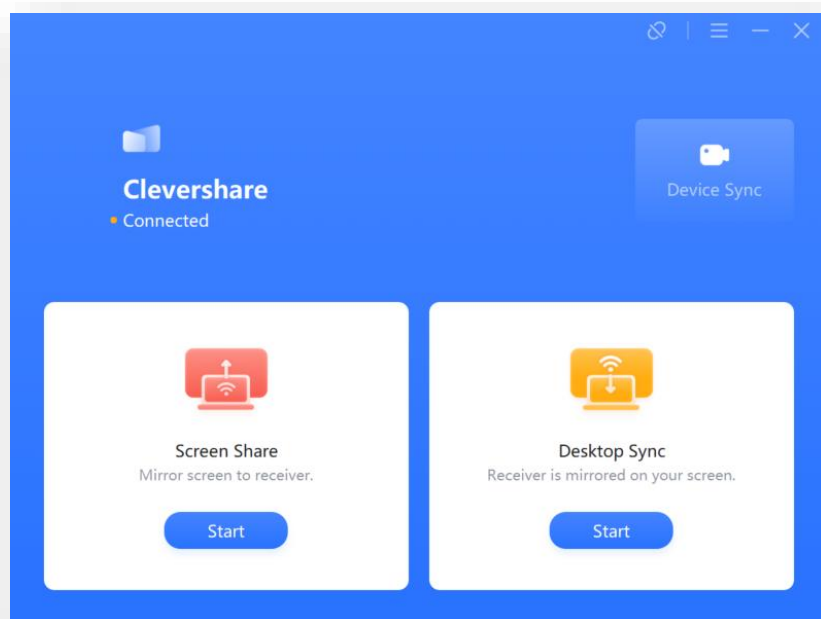

## Screen Share

To begin Screen Share, select “Start”

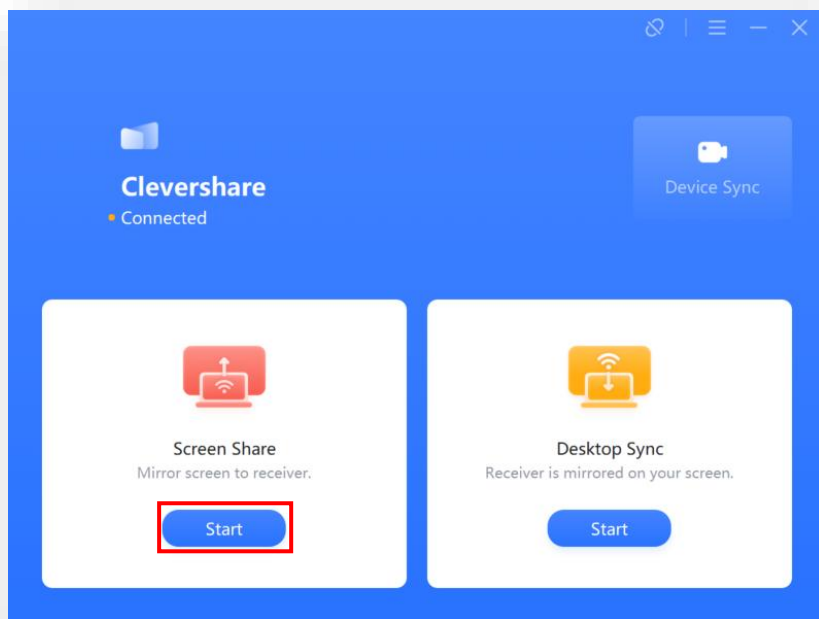

Choose the screen or window you would like to share and select “Mirror”. Or you can choose to extend your desktop.

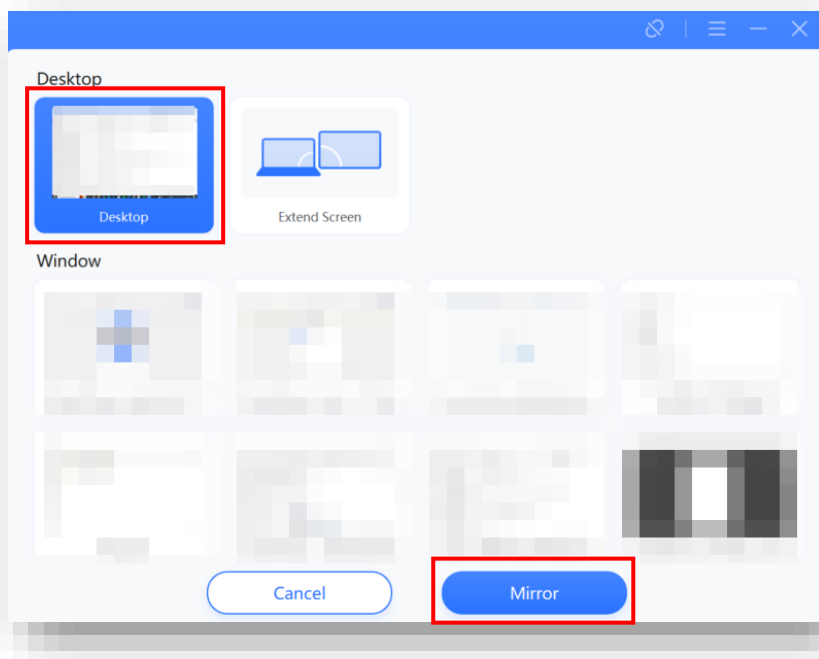

Accept the request on-screen.

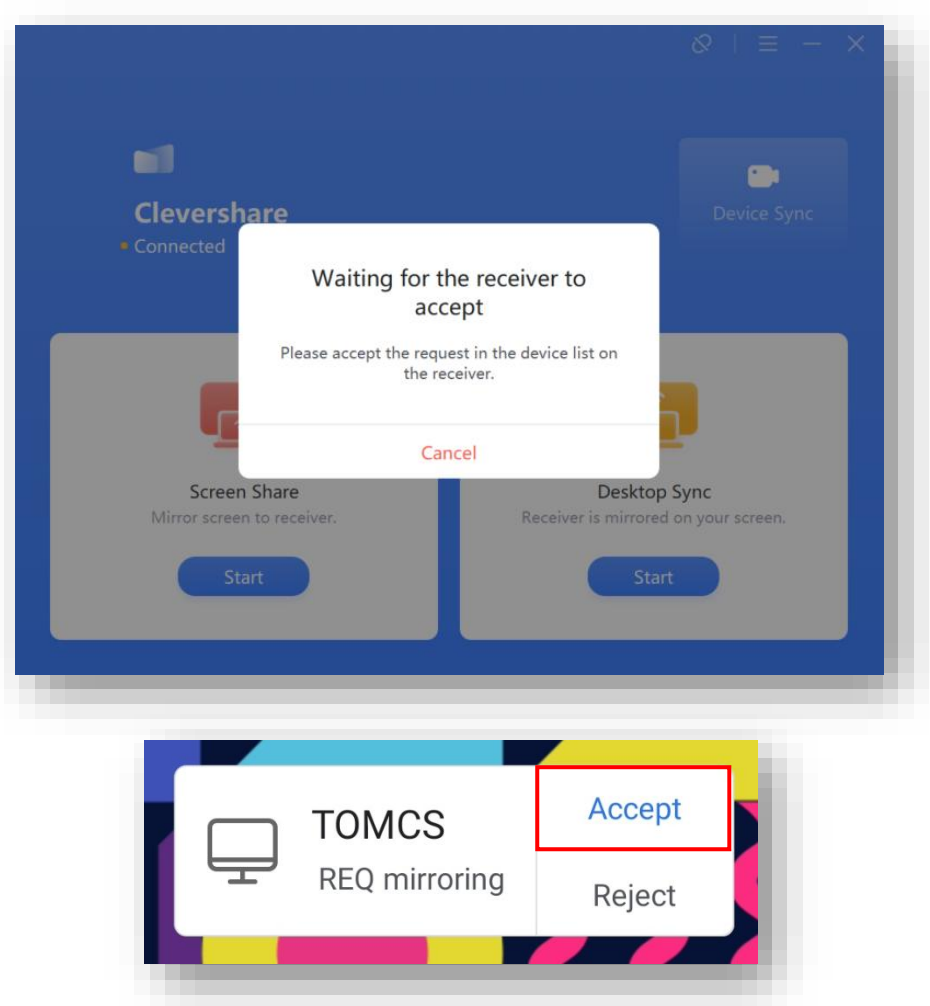

## Desktop Sync

To begin Desktop Sync, select “Start”.

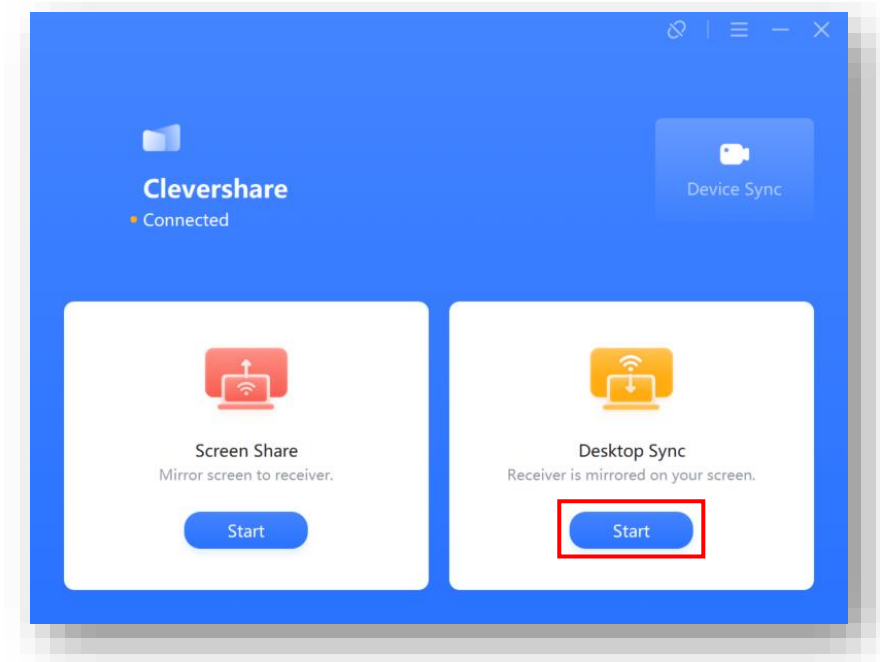

Accept the request on-screen.

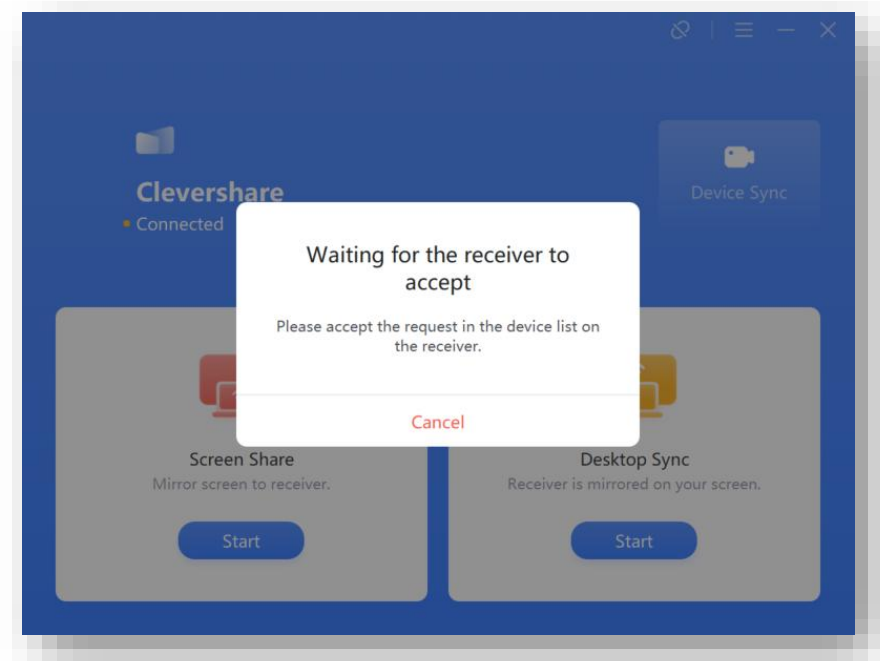

Select “Start” on screen.

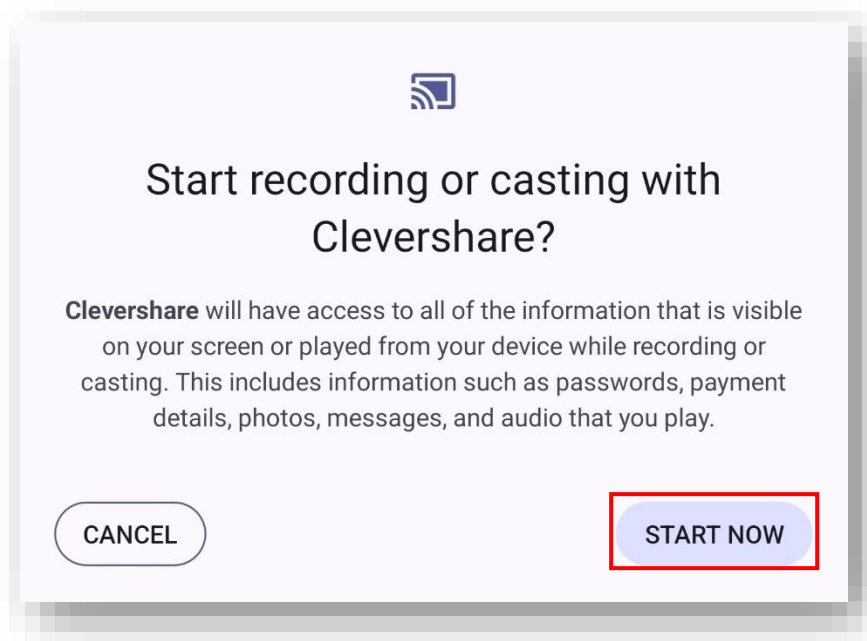

You will now be able to see your screen on your device.

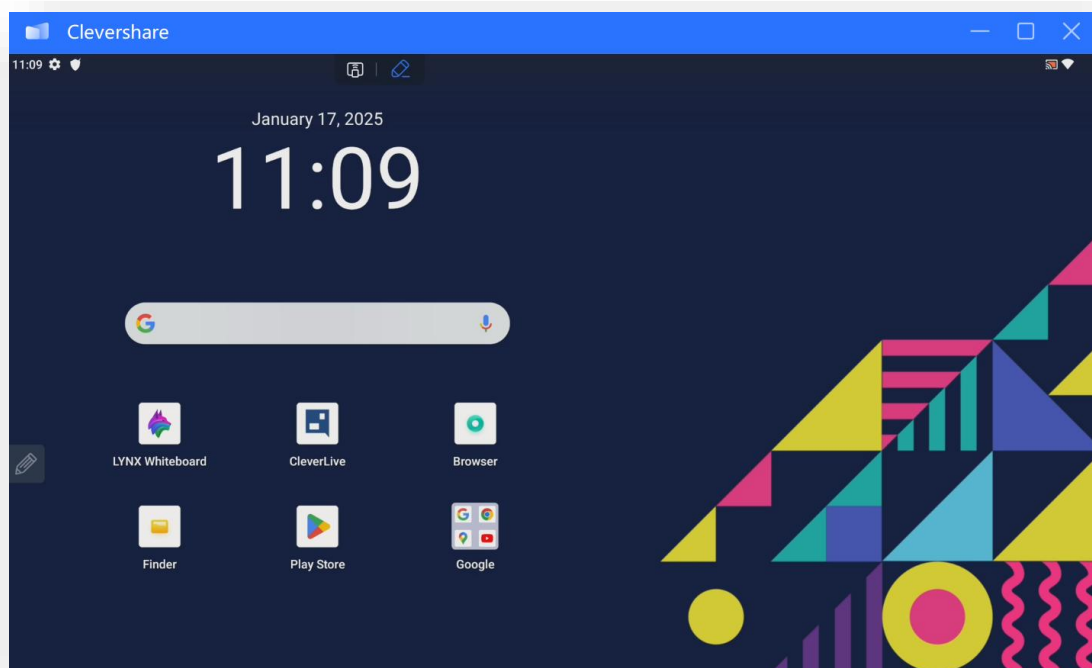



### *Authorising touch*

To authorise touch over Desktop Sync, Select Devices.

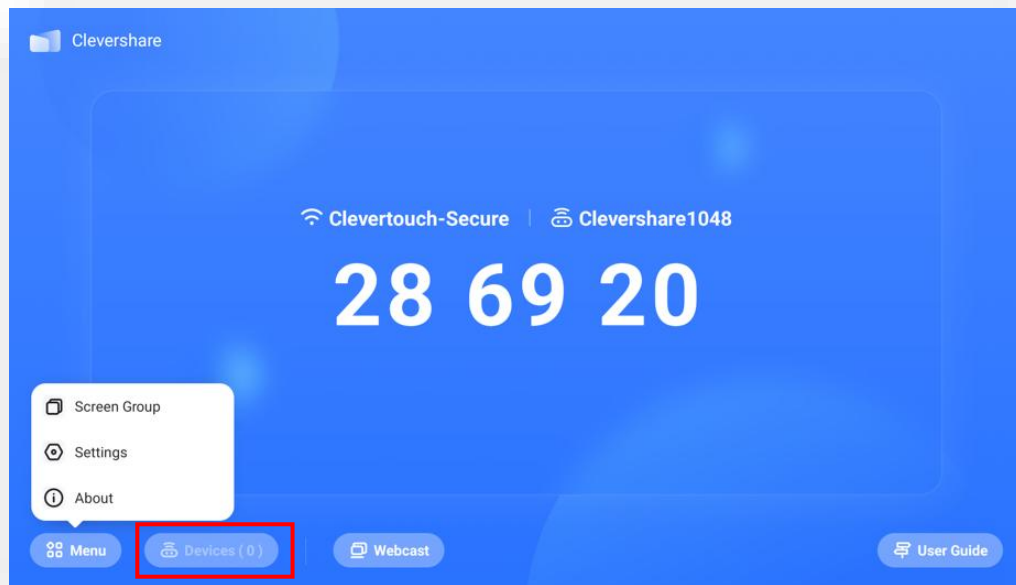

Select the finger icon.

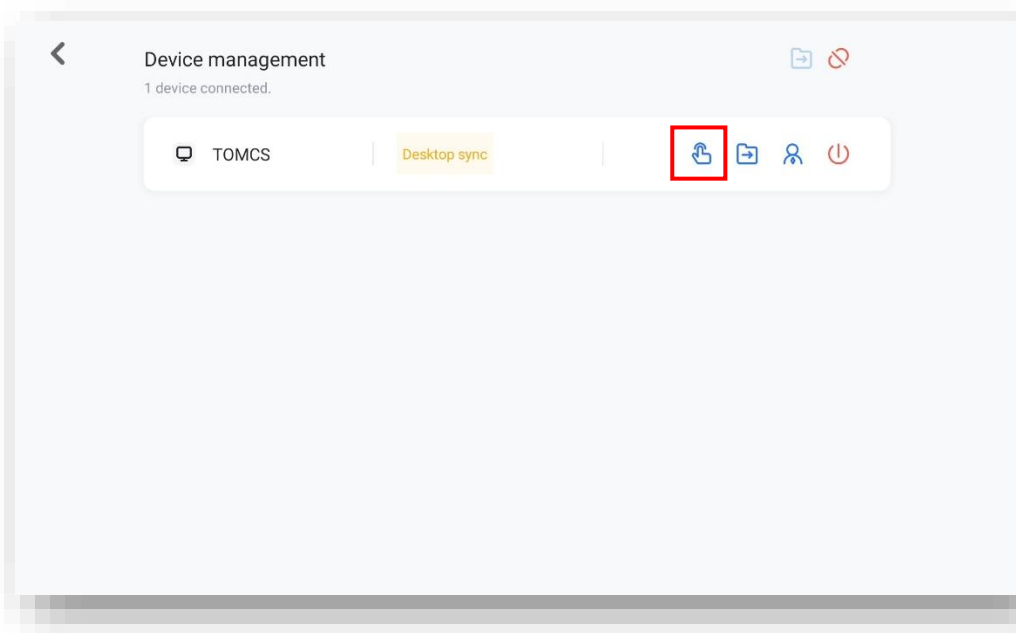

Select “Authorize”.

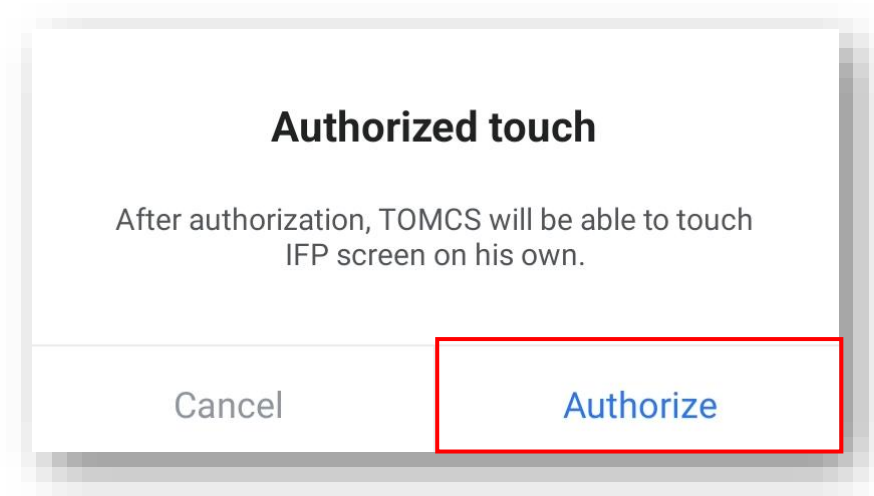

## Desktop application (Mac OS)

For Mac OS, everything will be the same however you will have the added feature of “Privacy Desktop”.

When you first open the desktop application, you will need to enter the 6 digit code shown on your Clevertouch screen.

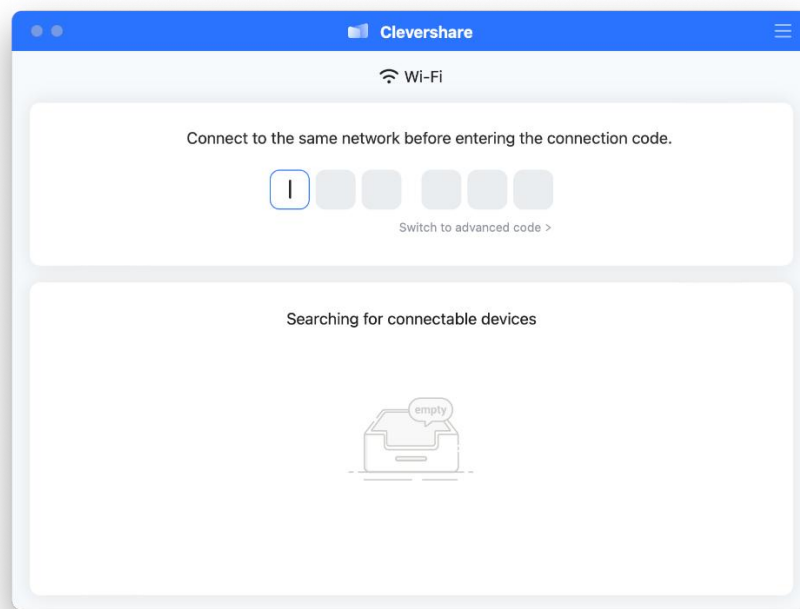

Once connected, you will see the following screen.

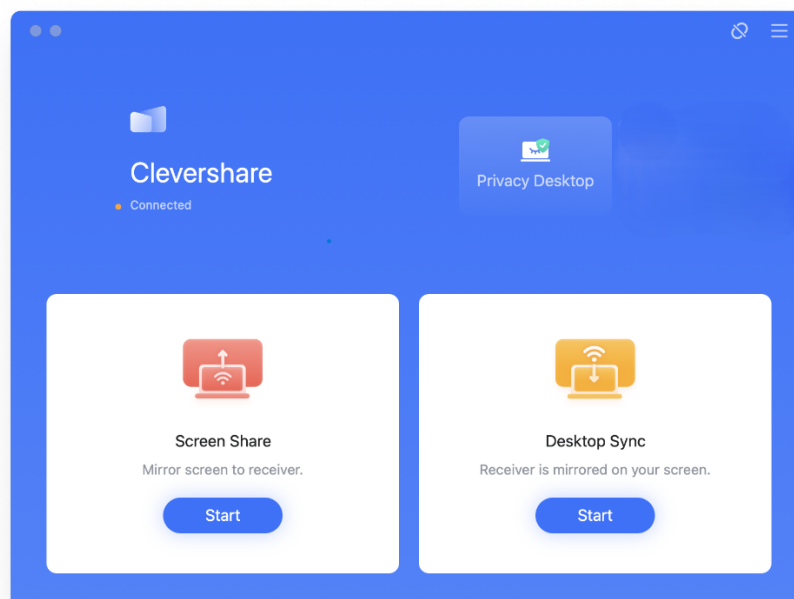

## Screen Share

To begin Screen Share, select “Start”

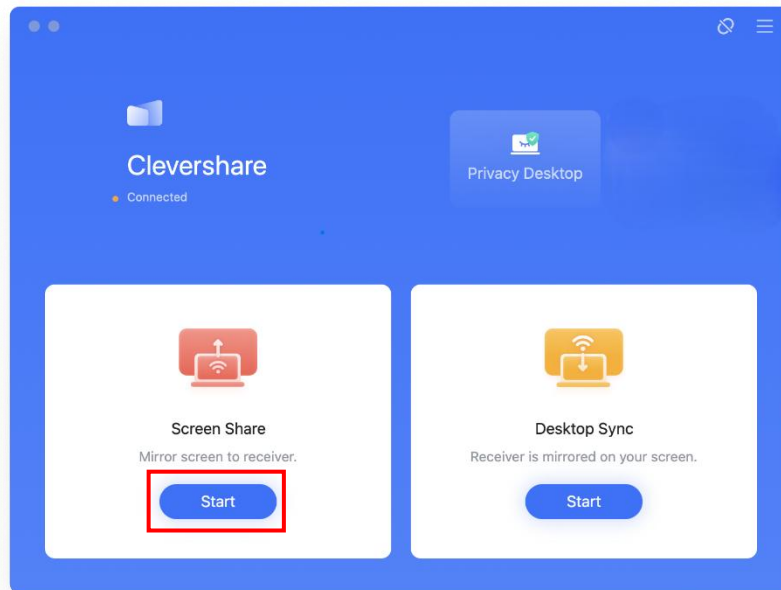

Choose the screen or window you would like to share and select “Mirror”. Or you can choose to extend your desktop.

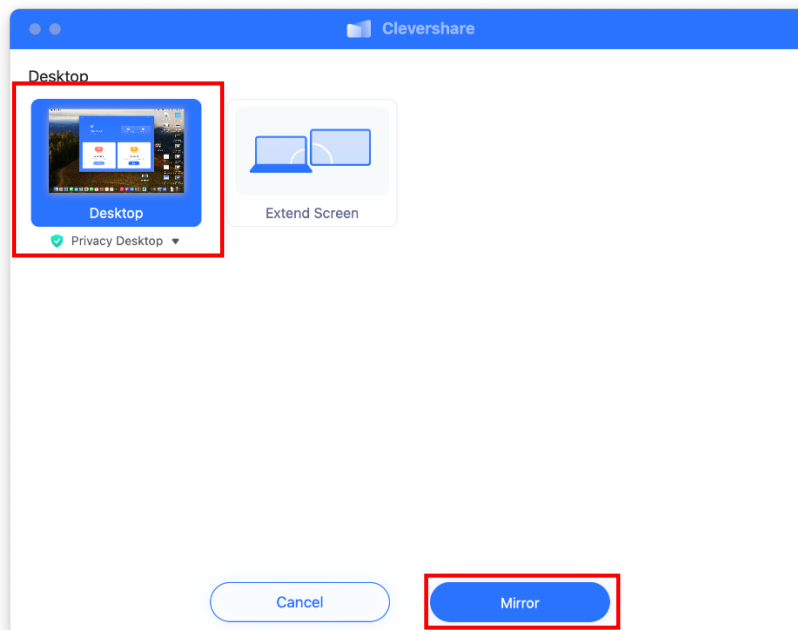

Accept the request on-screen.

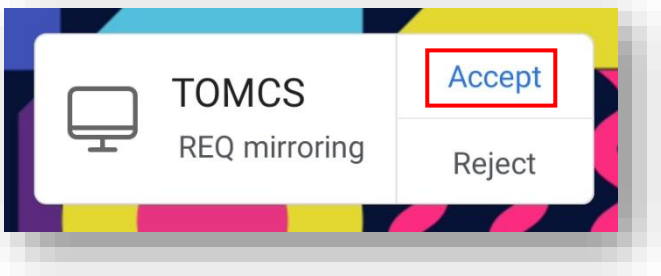
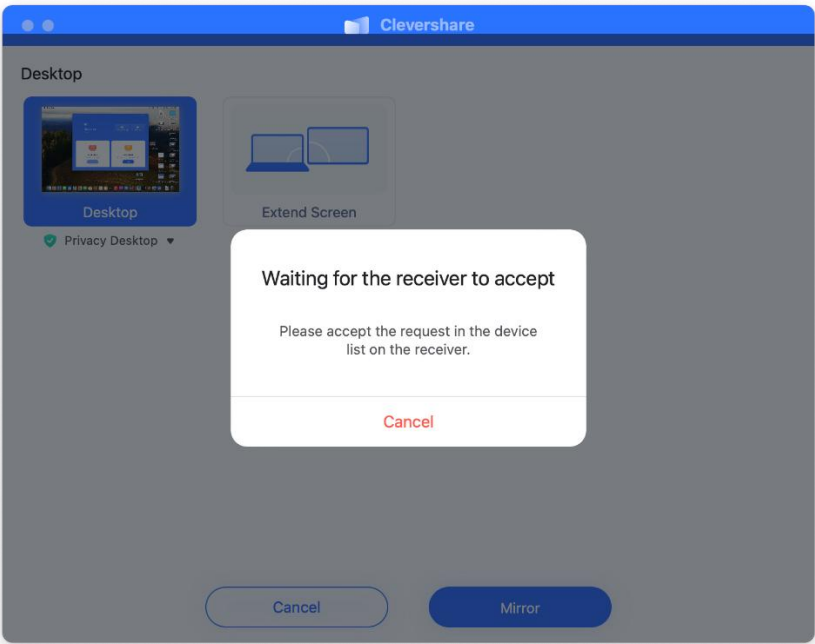

## Desktop Sync

To begin Desktop Sync, select “Start”.

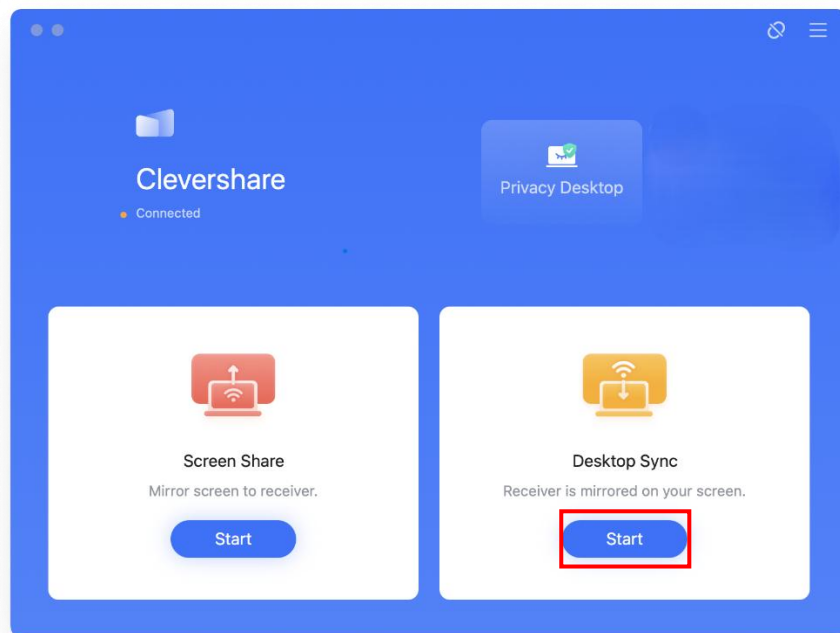

Accept the request on-screen.

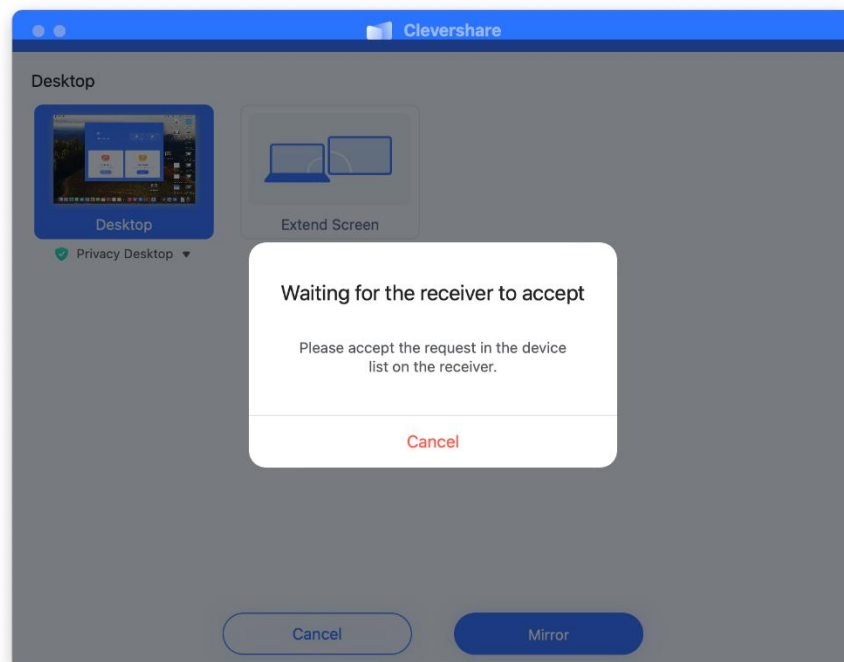

Select “Start” on screen.

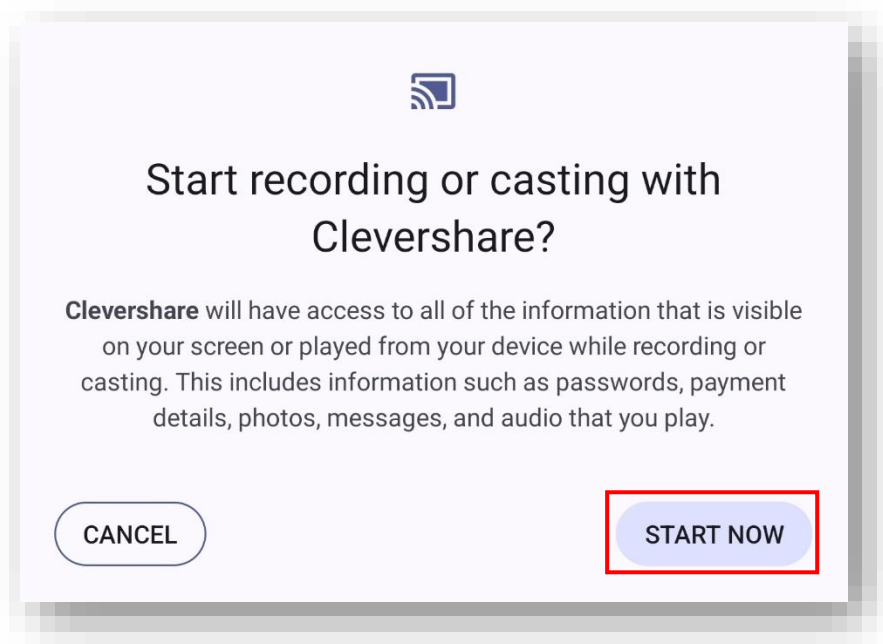

You will now be able to see your screen on your device.

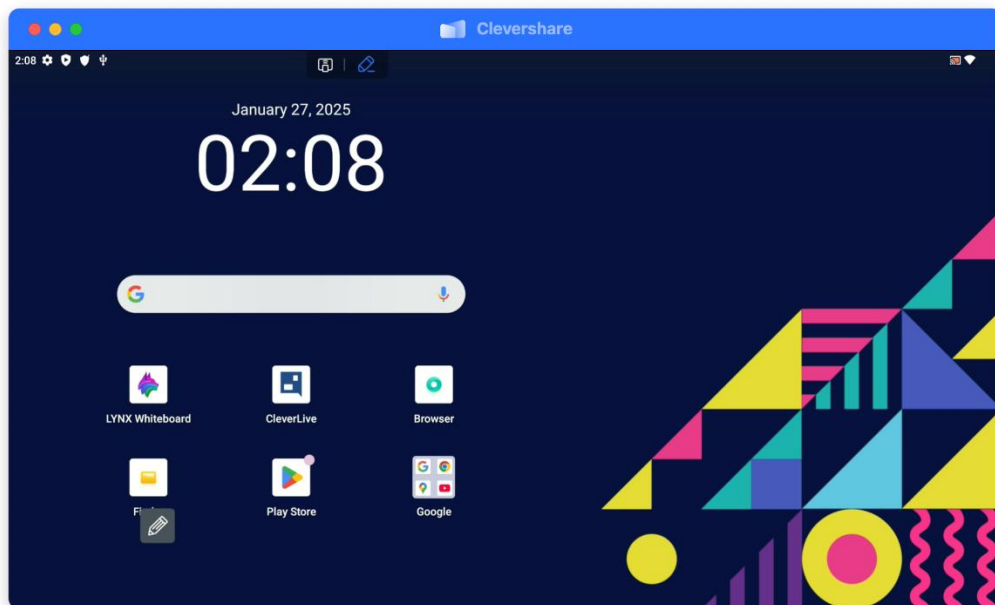

### *Authorising touch*

To authorise touch over Desktop Sync, Select Devices.

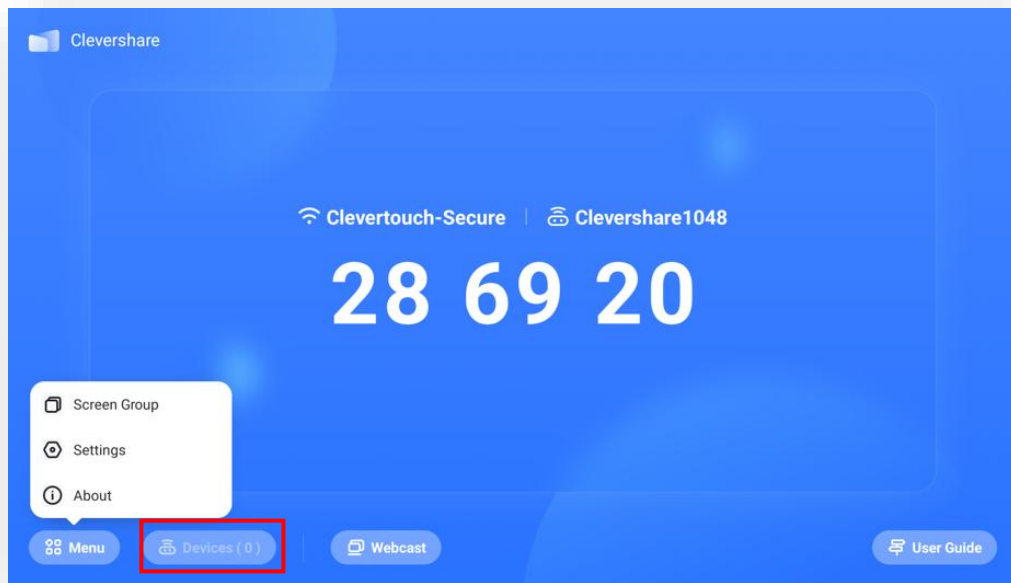

Select the finger icon.

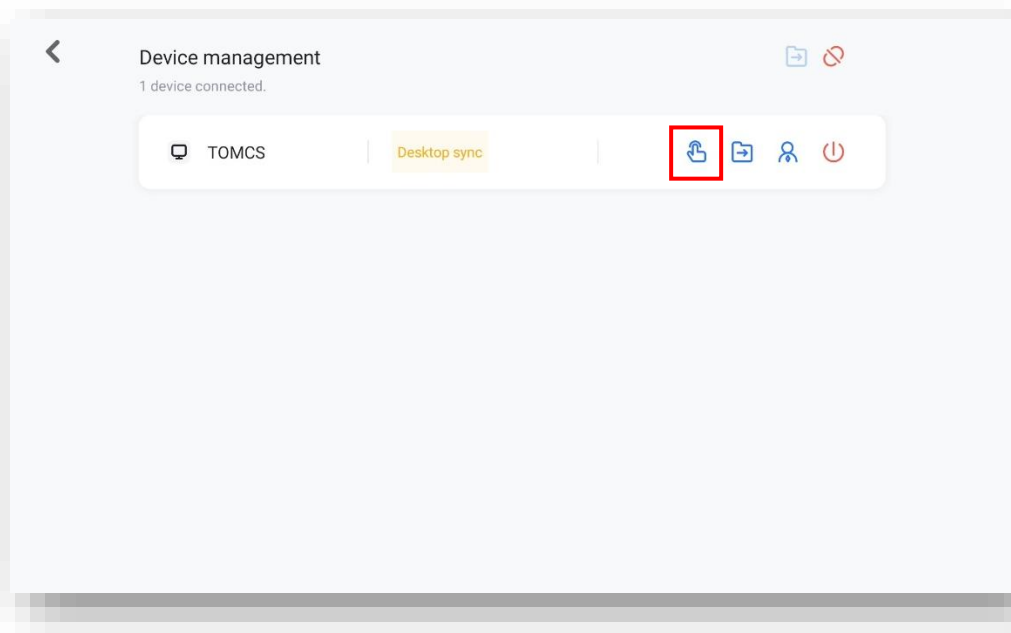



Select “Authorize”.

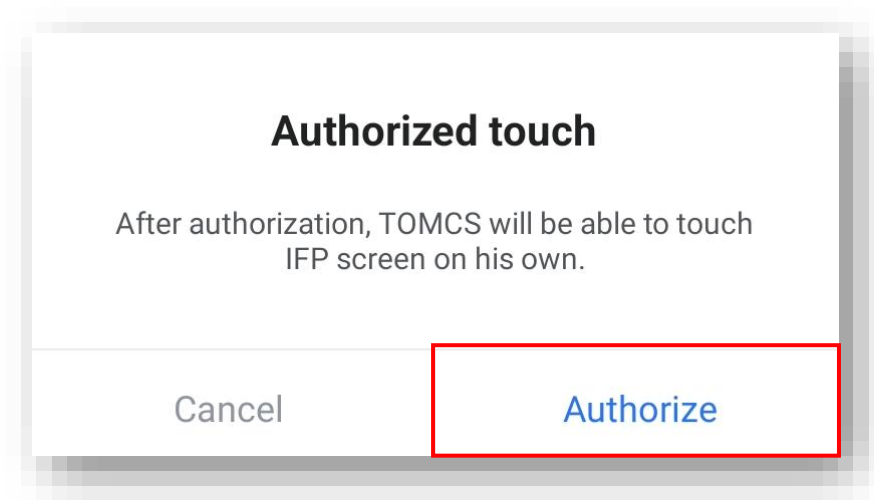

## Privacy Desktop

When connected to Clevershare, select “Privacy Desktop”

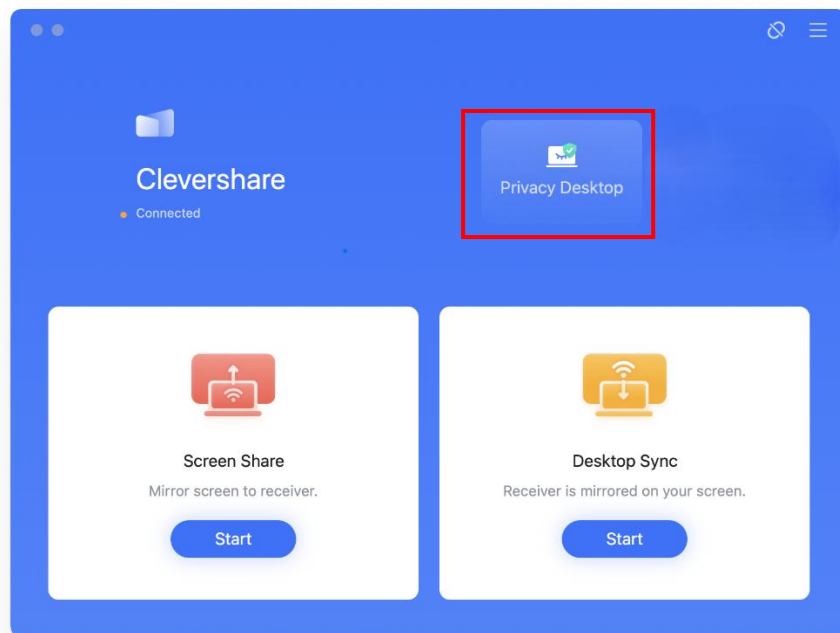

From here, you can hide all notifications, and you can hide certain apps on your desktop.

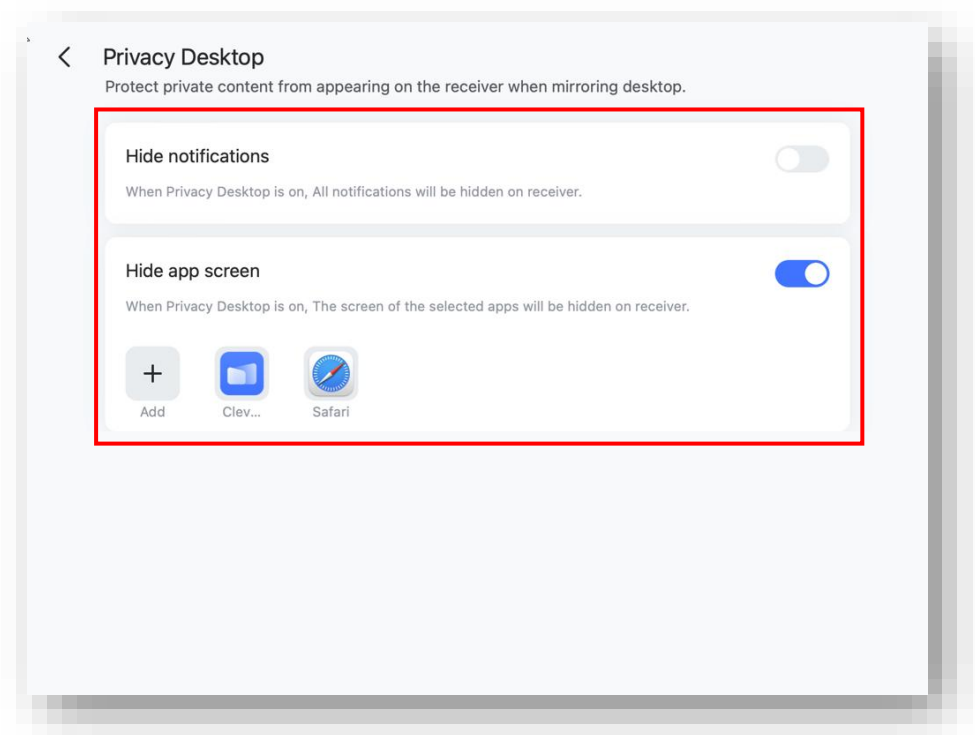

## Mobile Application (Android & IOS)

When you first open the desktop application, you will need to enter the 6-digit code shown on your Clevertouch screen.

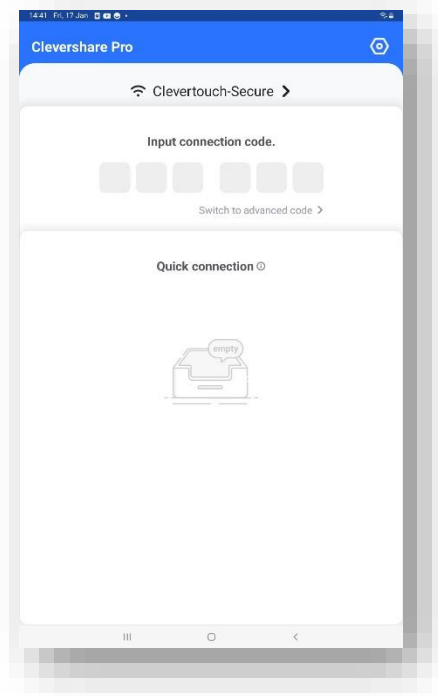

Once connected, you will see the following screen. To screen share, select “Start”

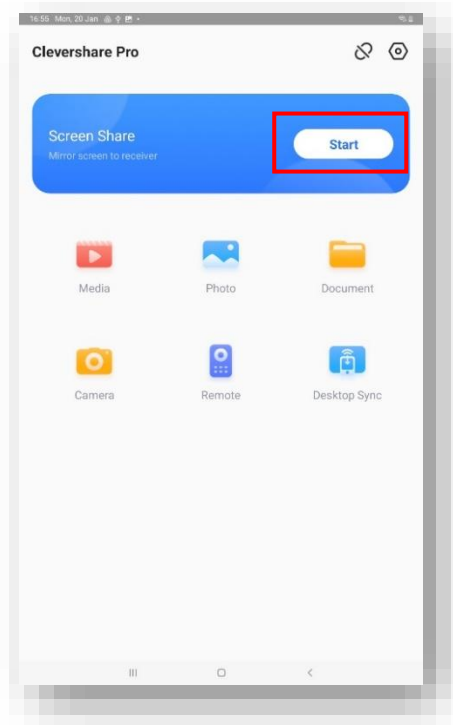

Select Media to share media to the Clevertouch screen.

Select Photo to share an image on the Clevertouch screen.

Select Document to share a document to the Clevertouch screen.

Select camera to record and cast on the Clevertouch screen.

Select Remote to take control of the Clevertouch screen.

Select Desktop Sync to transfer the contents of the Clevertouch screen to the mobile device.

### NFC Cast (Android only)

Open the Clevershare application on your mobile device. Hold your device against the NFC reader of the screen. Follow the on-screen interface for sharing your device.

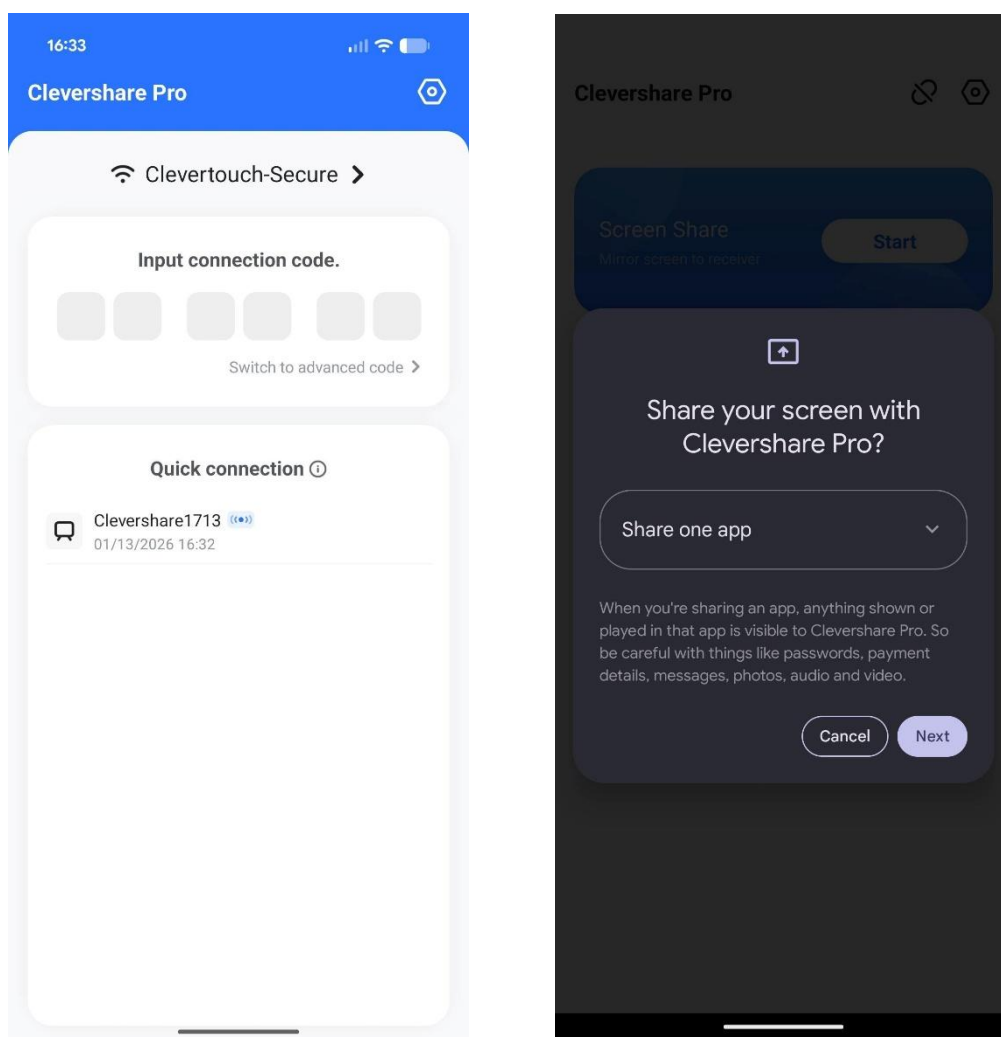

\*NFC cast is only supported when using a wireless network or device hotspot\*

# Screen Grouping

## Creating a group

On your Clevertouch device that you wish to have as your main screen, select “Menu” then “Screen Group”.

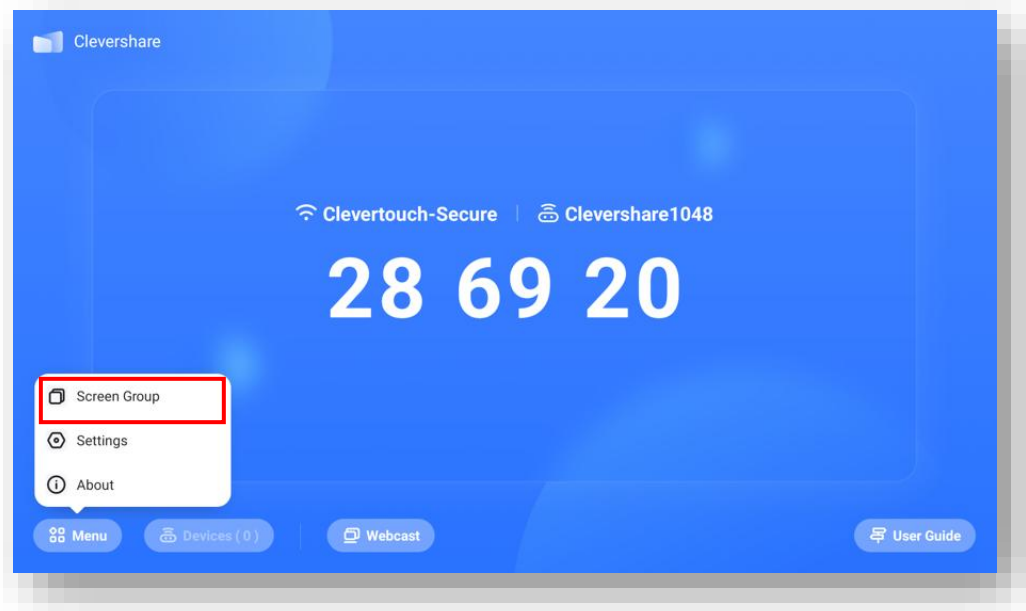

Select “Create Group”.

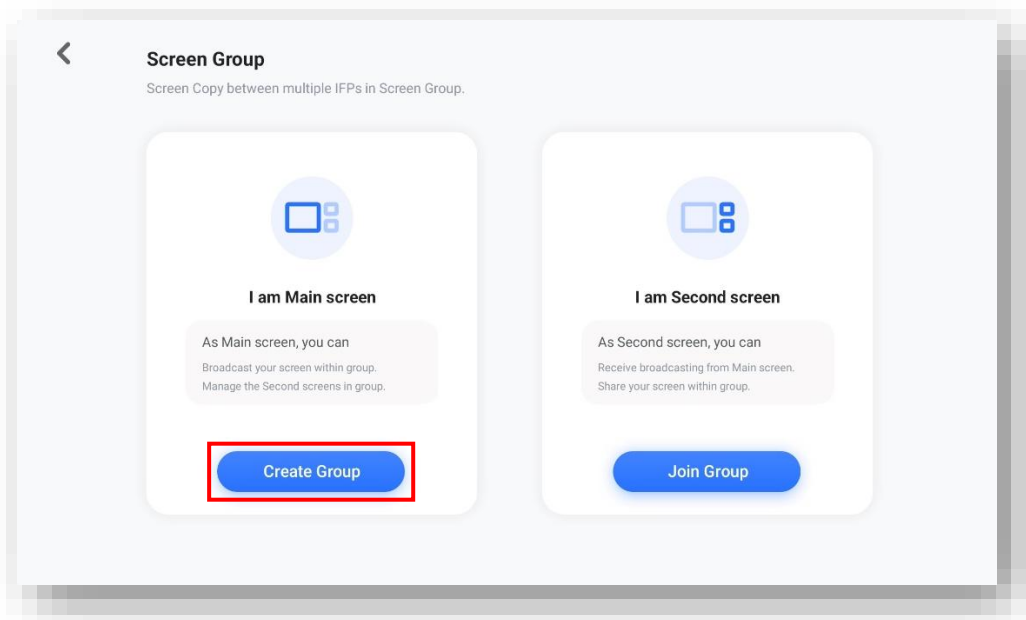

Once created, you will see the following.

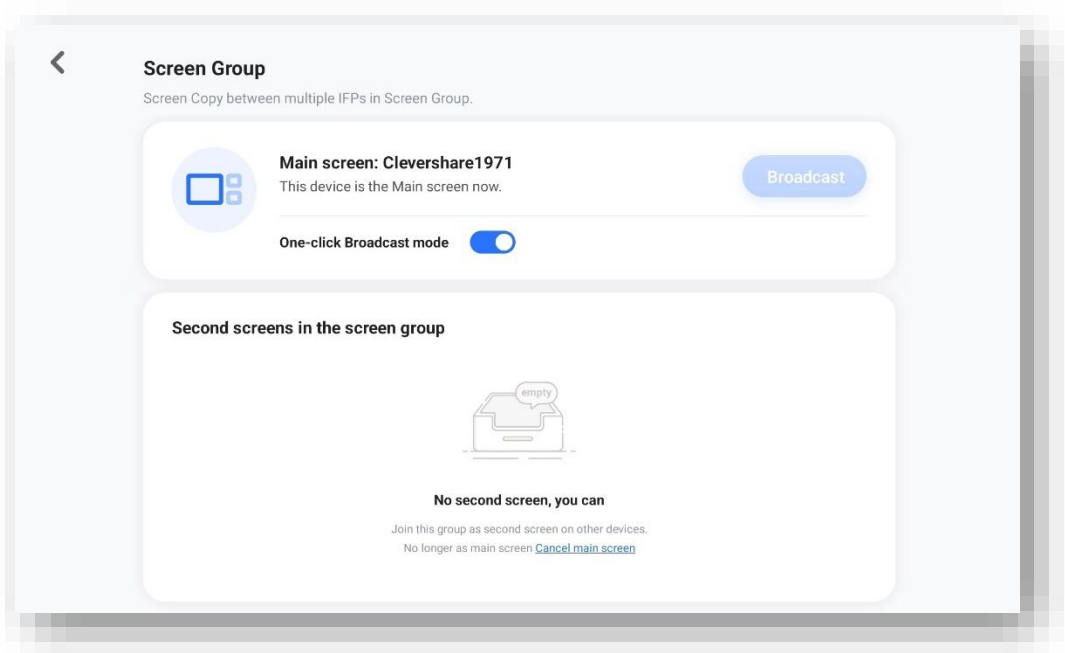

## Joining a group

On your secondary device, select “Menu” then “Screen Group”.

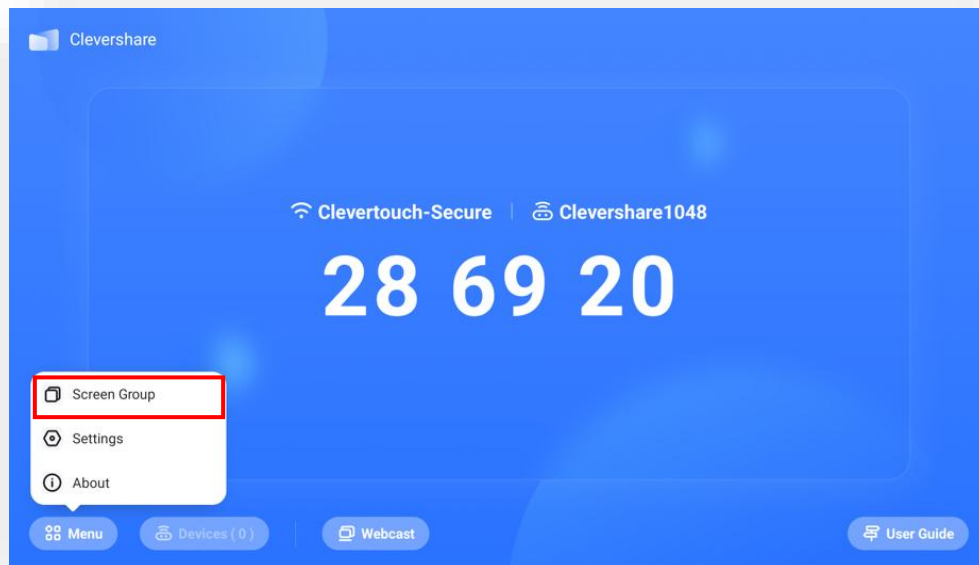

Select “Join Group”.

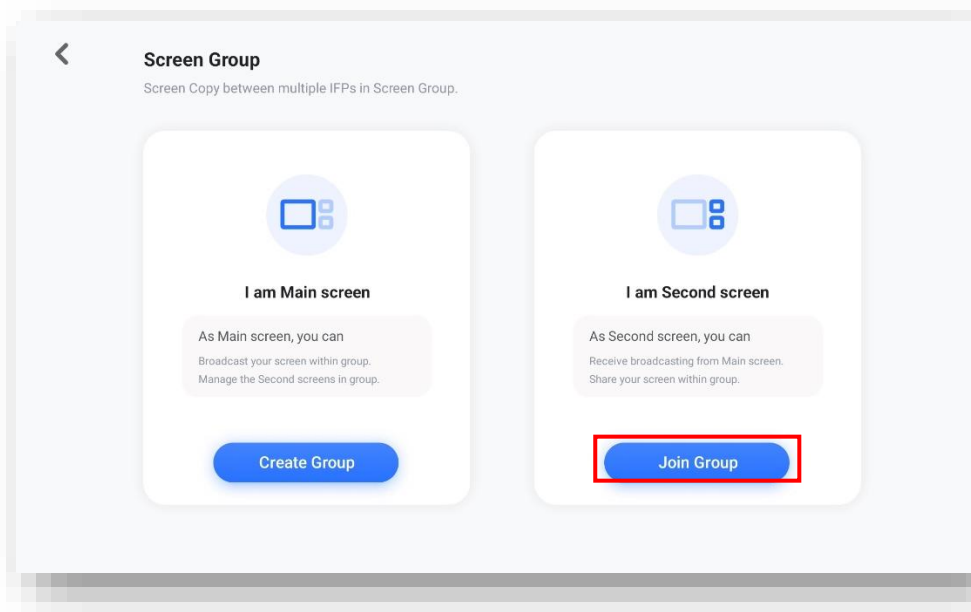

Join the main screens group by selecting “Connect and join”.

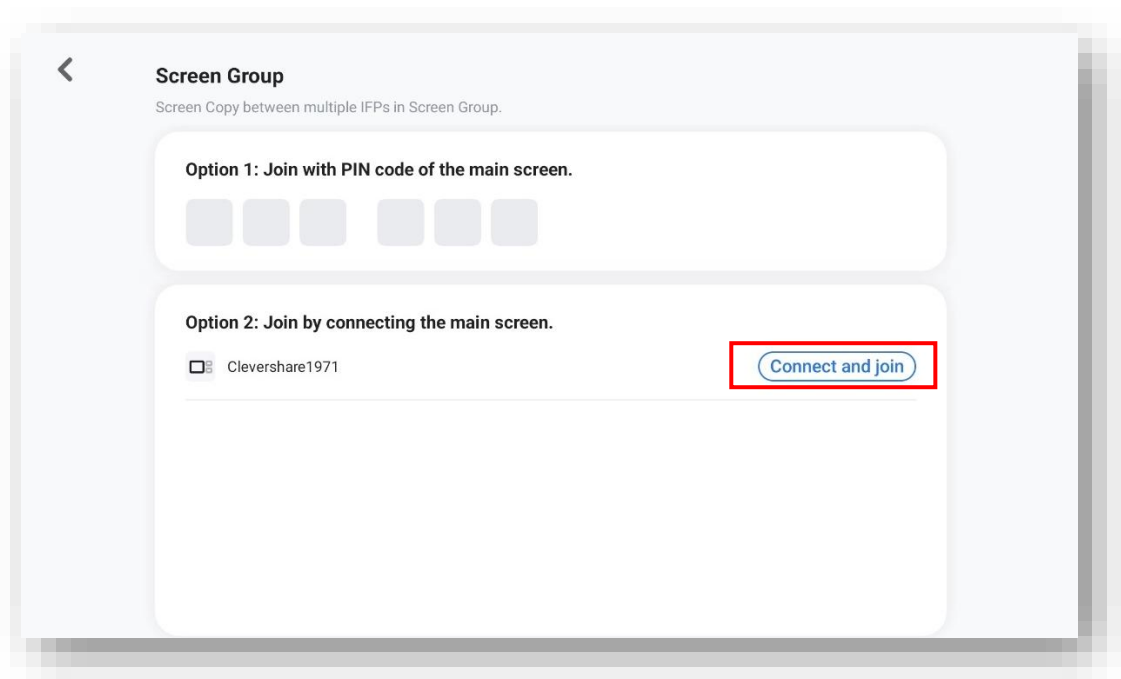

Once you have joined, you will see the following.

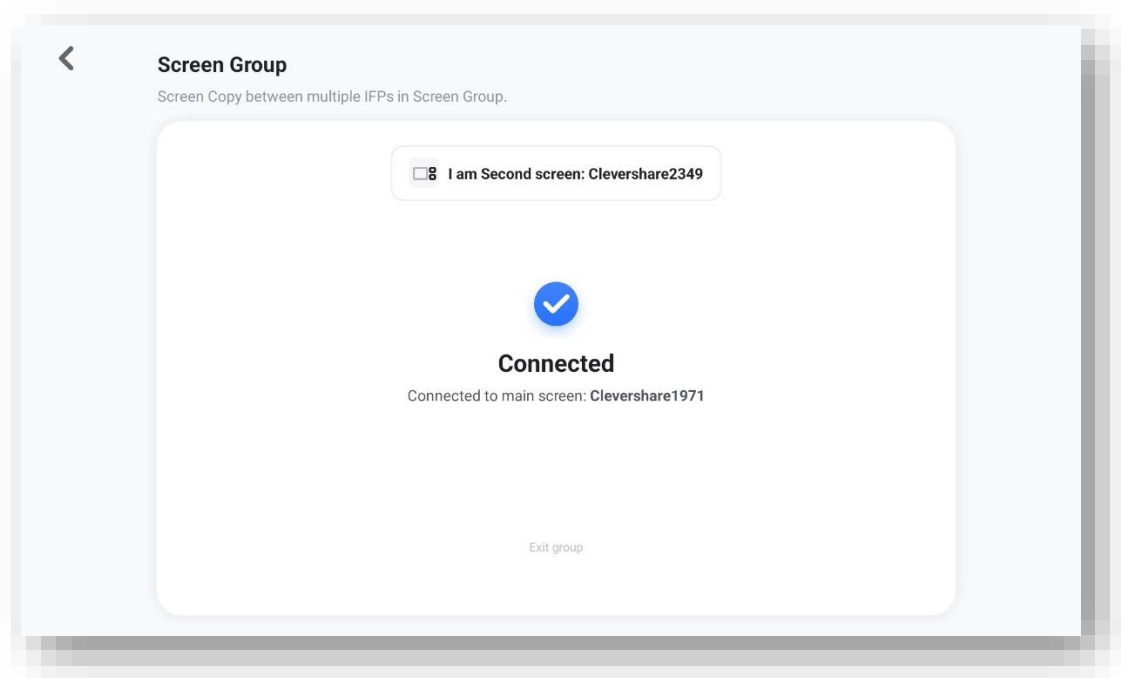



## Broadcasting to a group/secondary screen

On your main screen, select “Broadcast”.

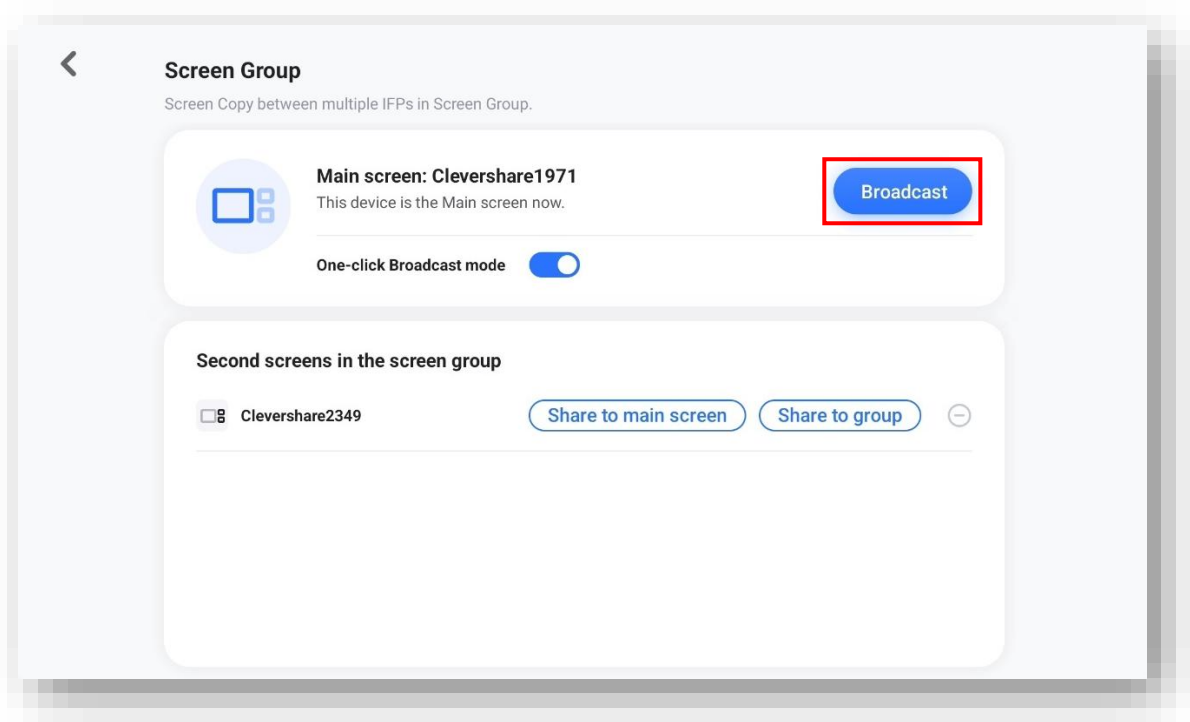

Your main screen will now be broadcast to all screens in your group.

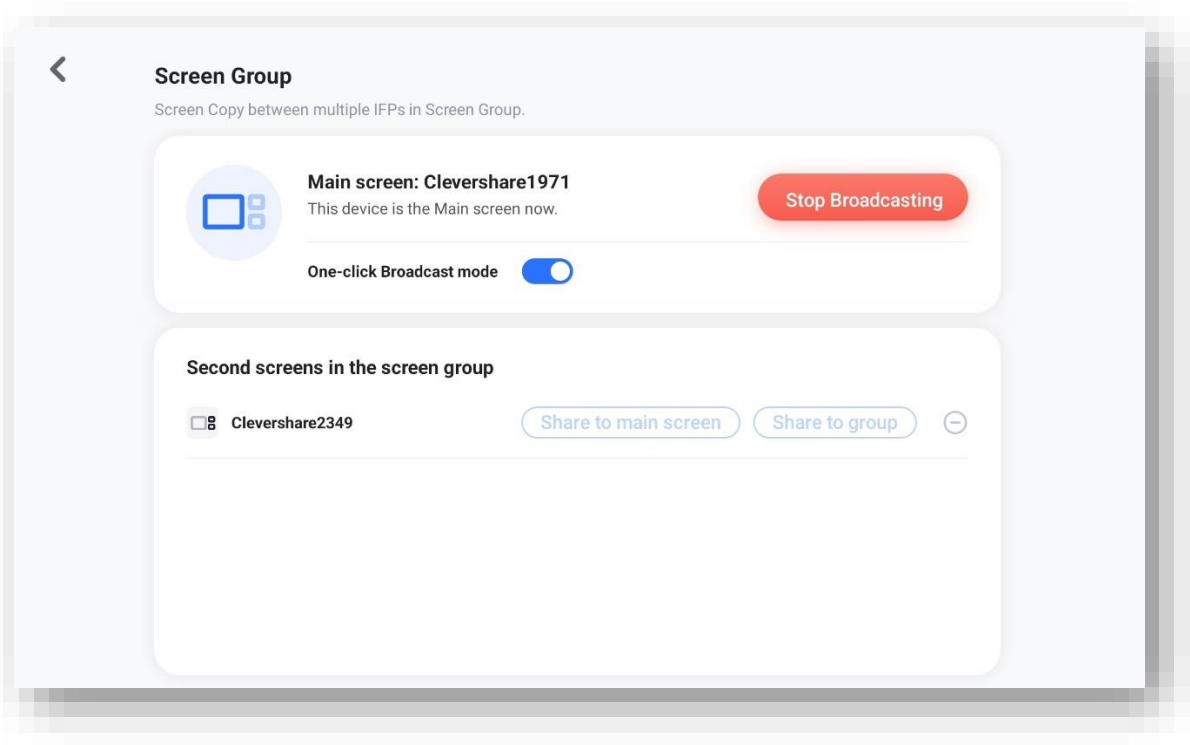

## Other features

### Sharing your secondary screen to a main screen

On your main screen, select the screen you would like to view and select “Share to main screen”.

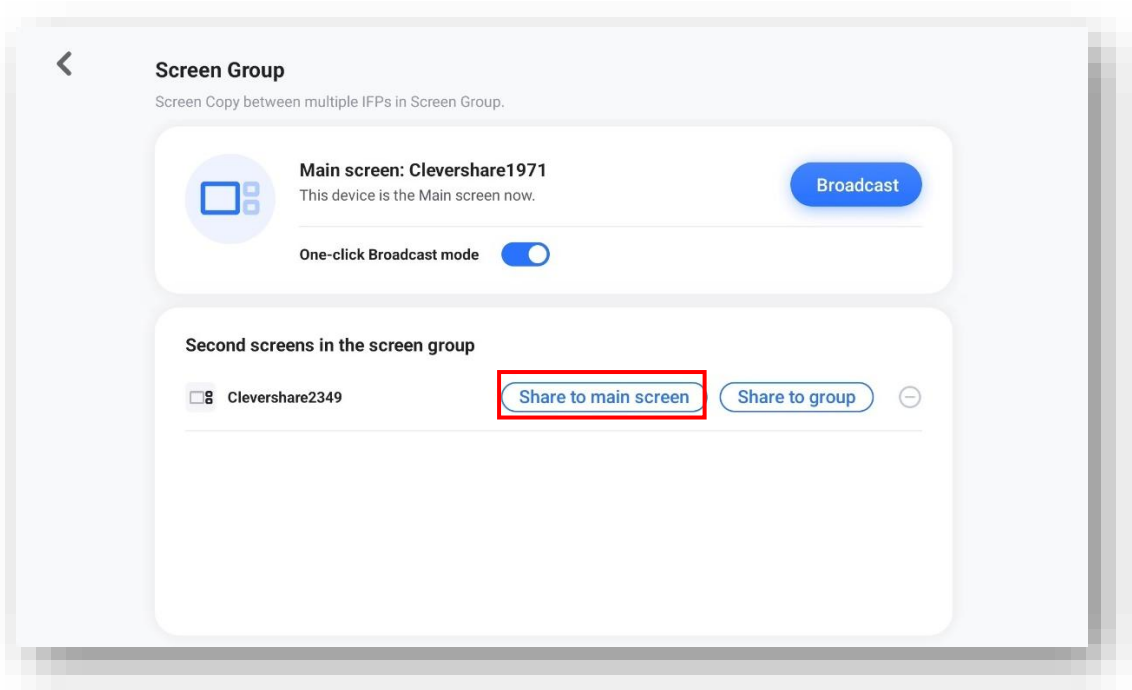

### Sharing your secondary screen to the group

On your main screen, select the screen you would like to view on all screens in the group and select “Share to main screen”.

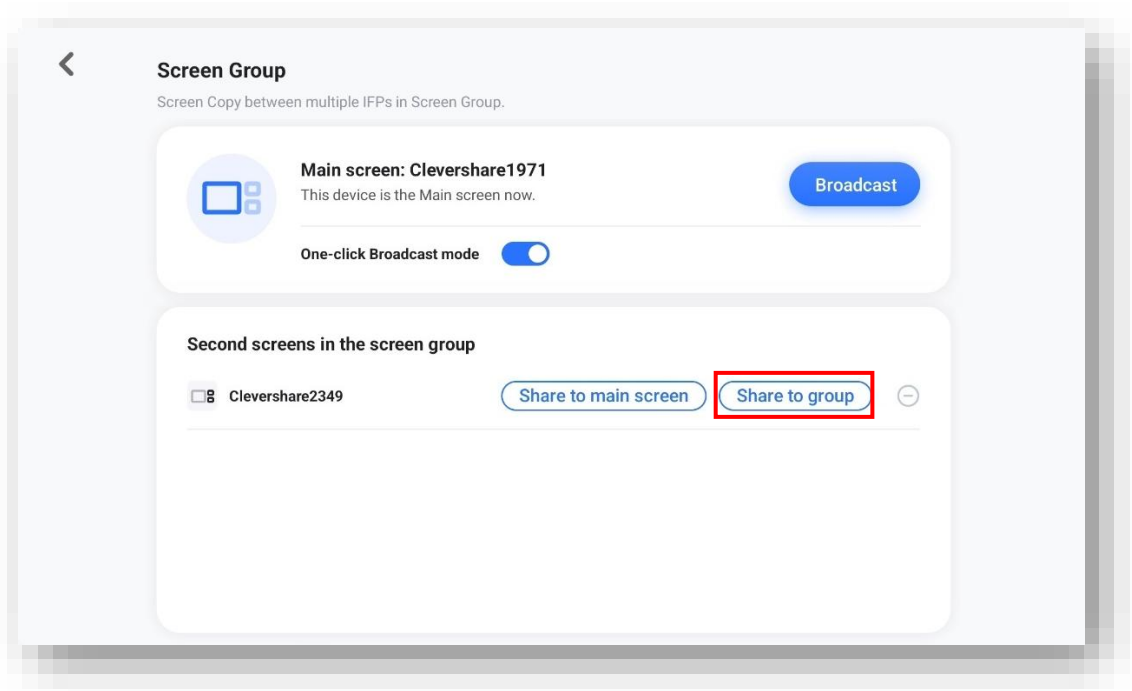

# CleverCast

## Pairing your CleverCast

On your device, make sure Hotspot is enabled and set to 5GHz. Give your Hotspot a unique name.

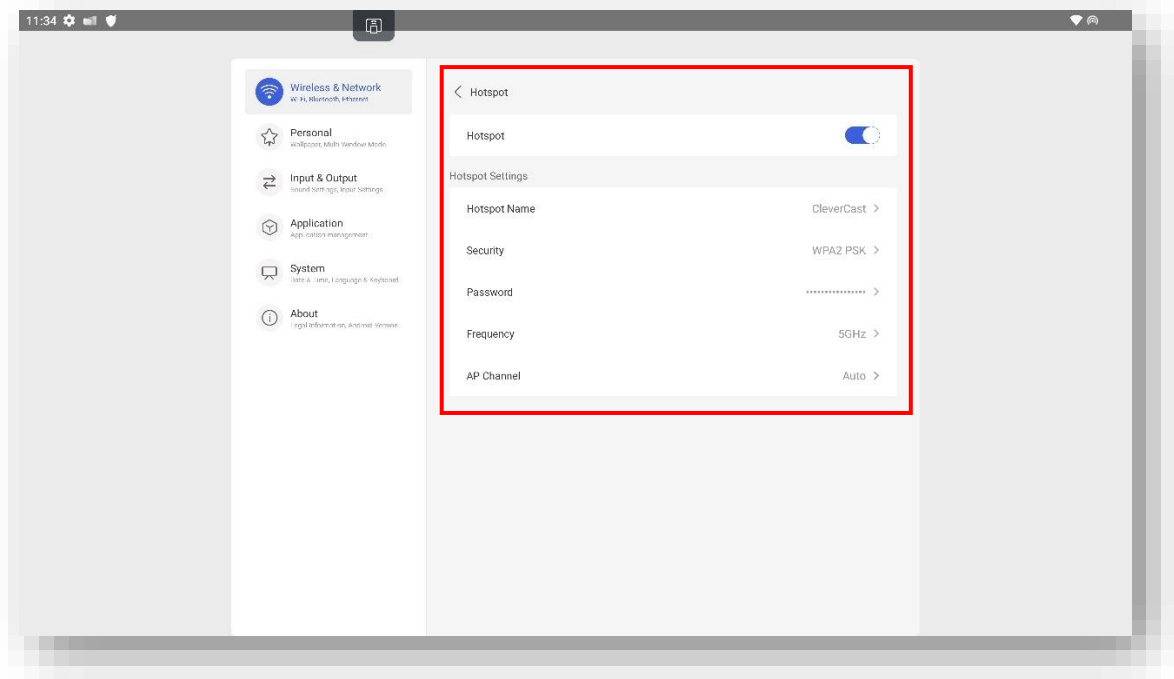

Plug your CleverCast into a USB-C port on your device and wait for it to pair. You will see the following message.

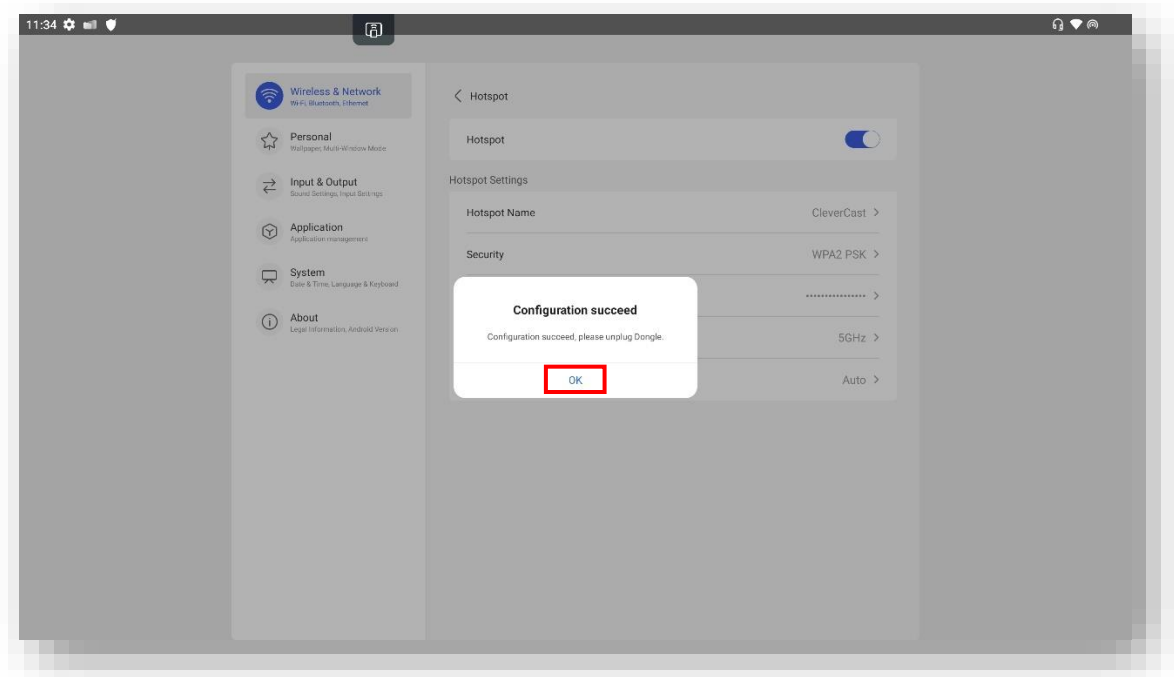

## Sharing your Clevertouch display/device

After pairing your CleverCast with the Clevertouch device, connect it to the device you want to cast from (laptop, tablet, or phone). The LED will blink white, then turn solid white. Once the LED is solid, press the button to begin casting.

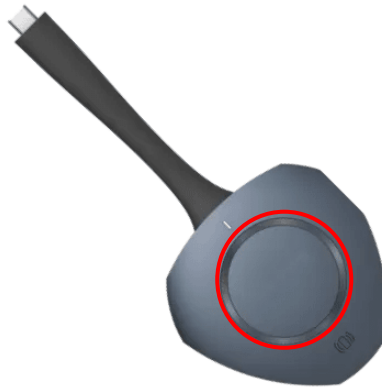

Your casting device will then be shown on your Clevertouch device.

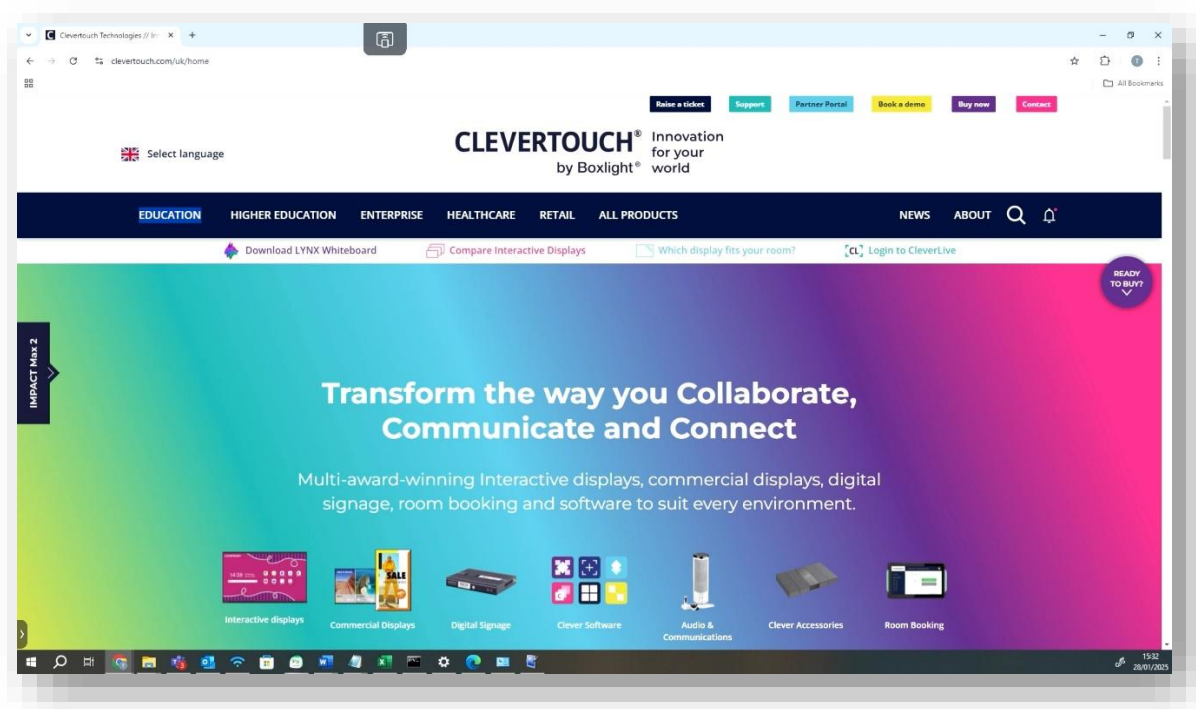

### *Sharing multiple devices*

If you wish to cast multiple devices to the Clevertouch device, you can hold the button, and the device will be added alongside any concurrent casts.

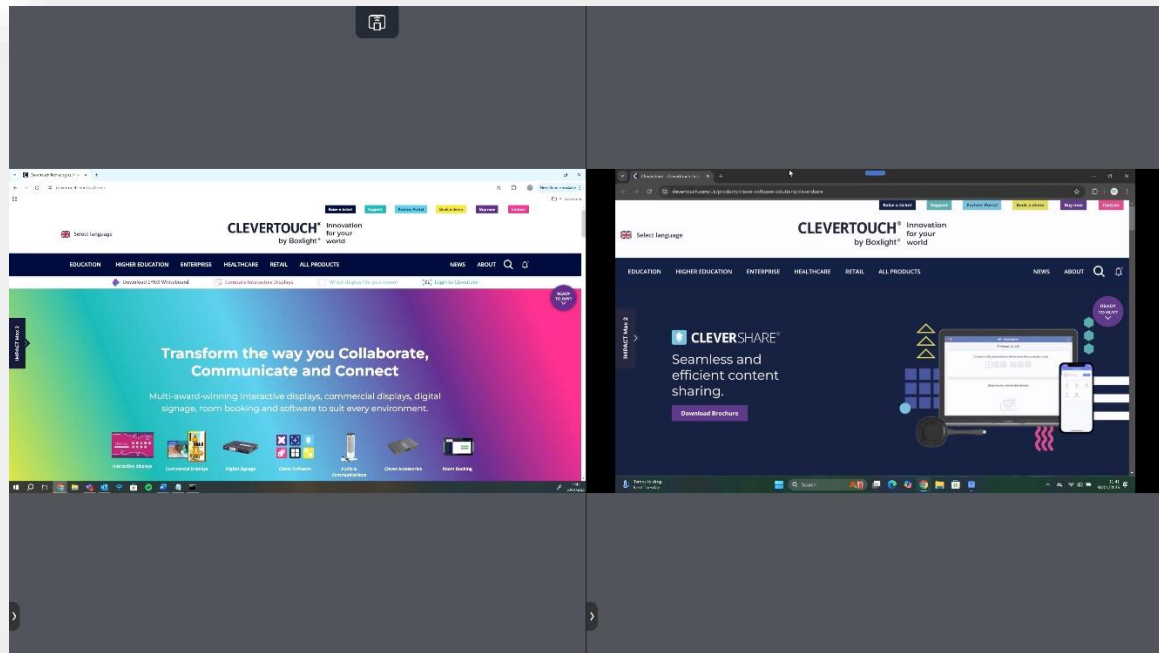

## Hardware Virtualization – Teams, Google Meet & Zoom

Once your CleverCast is paired with your Clevertouch device, you can use hardware virtualization. Plug your CleverCast into your laptop and follow the below steps. (Hardware virtualization is only available on the UX Pro Edge)

### Teams

Start a teams call and select the dropdown.

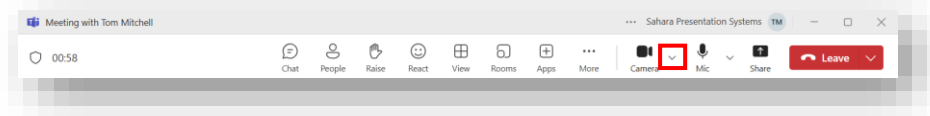

Select “M-Media” (Multi-Media).

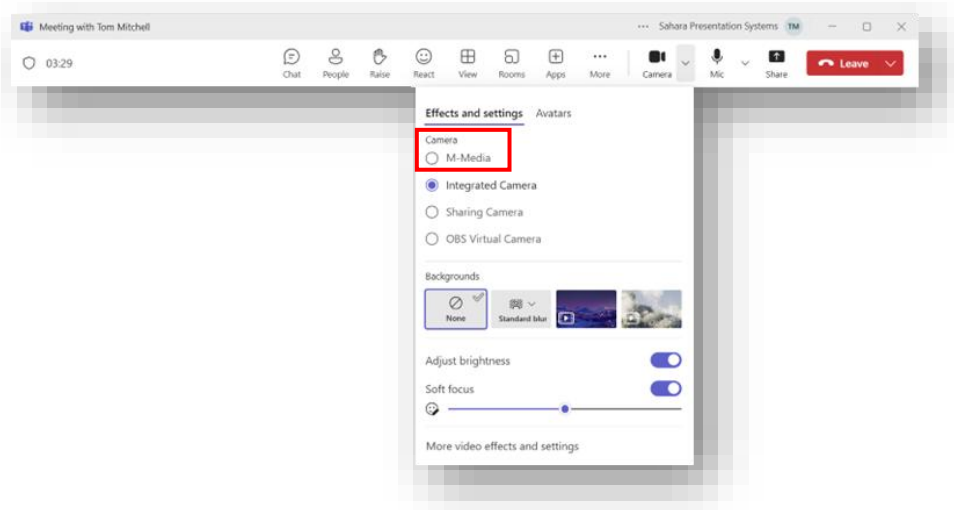

### Google Meet

Start a Google Meet call and select the dropdown.

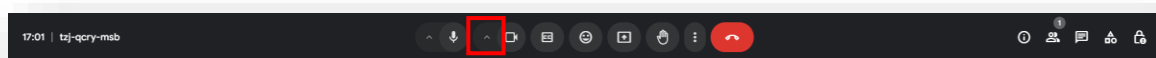

Select the second dropdown and then select “M-Media”.

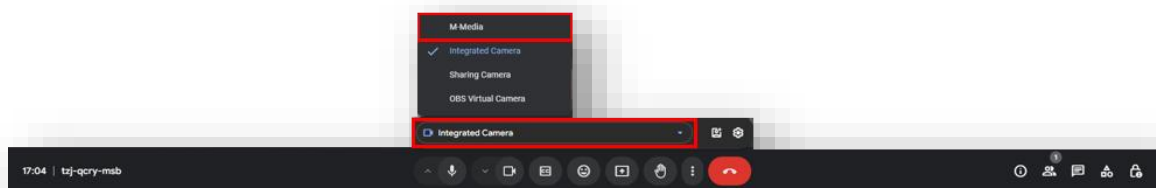

## Zoom

Start a Zoom call and select the dropdown.

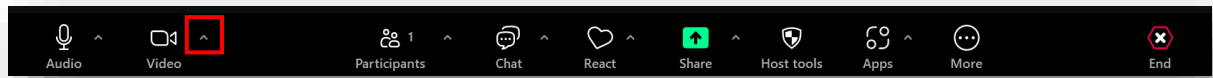

Select "M-Media".

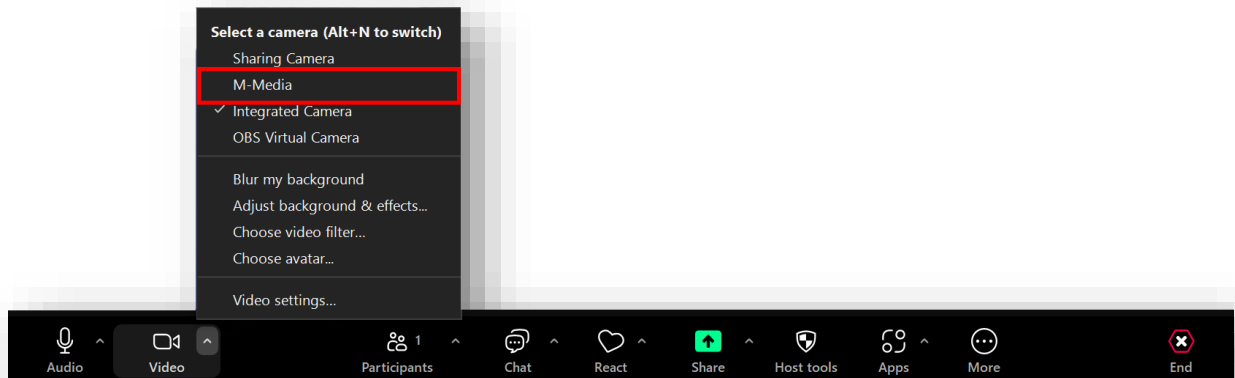

## FAQ's

*How do I update Clevershare?*

1. Select “Menu” then “About”.

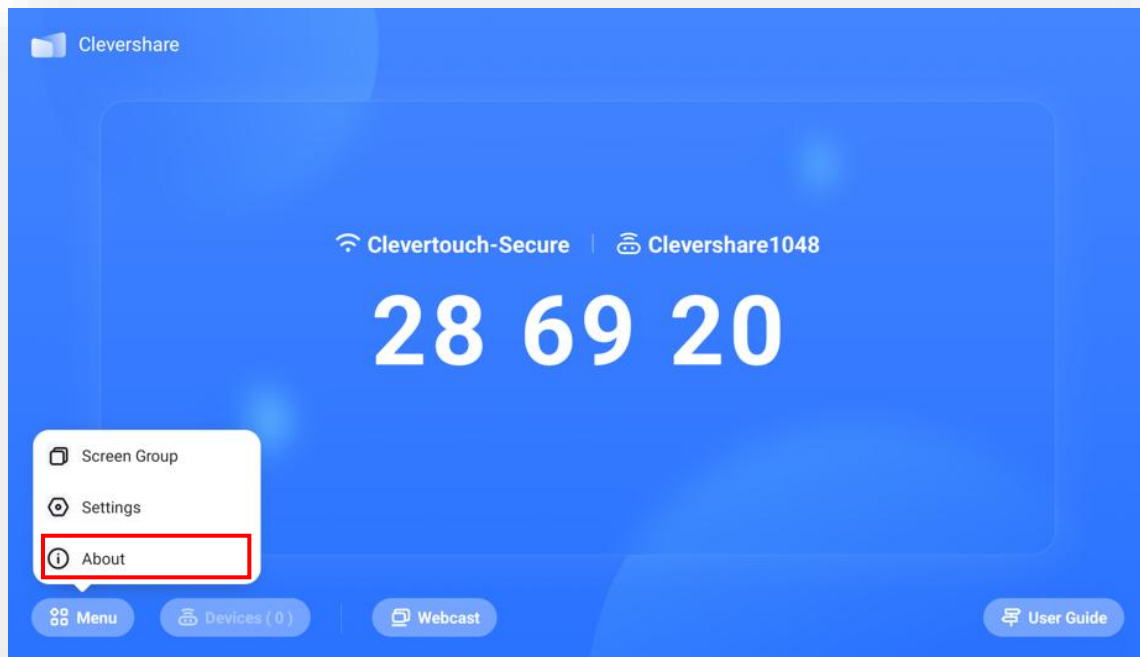

2. If an update is available, you can select “Update”. If there is no update, this page will let you know you are on the latest version.

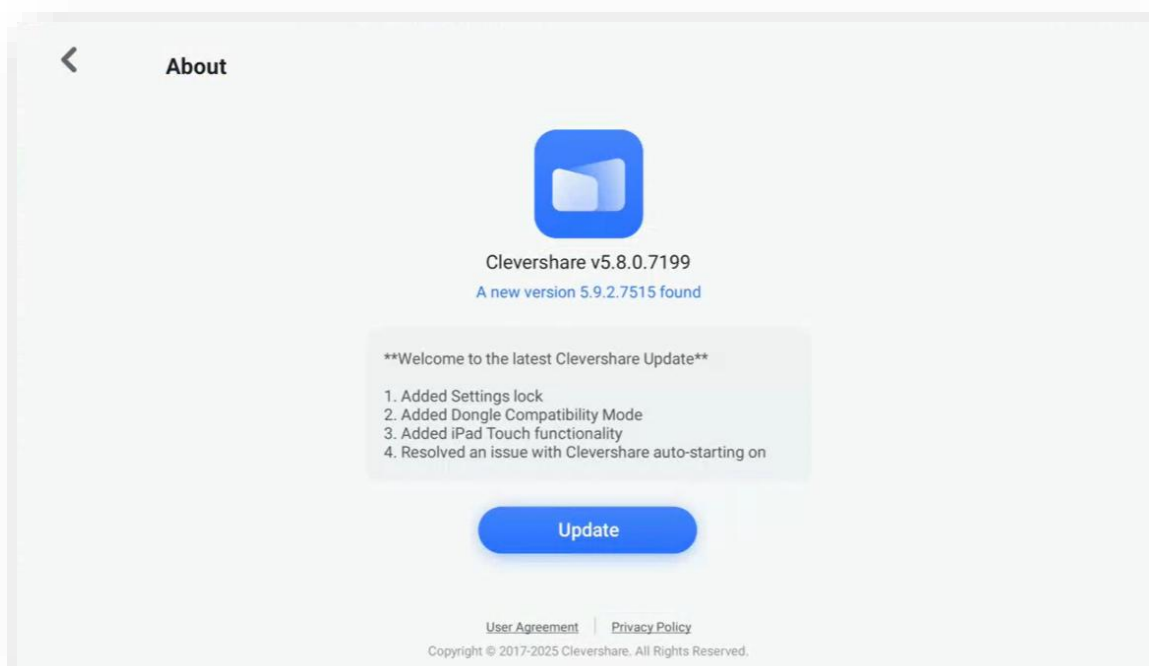



*What is my CleverCast compatible with?*

CleverCast is compatible with all devices running Android 11 and above.

*Can I use Webcast on any browser?*

Casting from a browser is best supported in Google Chrome. Other browsers may have limited or no support.